

NOTICE!!

These documents have been scanned!

Do not place un-scanned documents beneath this notice!

Do not remove this notice from this file!

GPO Jacket No. 560-102
Print Order 61540
Rise Business Services, LLC
Job=AZ15 5/15/2019



Box Number= AZ15052



Claim Begin-End: AMC413450-AMC413460

1 Initial Receipt



AZ15052-5

AMC413297-AMC418724

United States Department of the Interior
Bureau of Land Management
 LANDS/RECREATION & PLANNING
 ONE N CENTRAL AVE
 PHOENIX, AZ 85004 -2203
 Phone: 602-417-9200

Receipt

No:

2499503

Transaction #: 2576522

ENTERED INTO COMPUTER

Date of Transaction: 01/17/2012

CUSTOMER:

FEB 01 2012 *pb*

GOOD EARTH MINERALS LLC
 600 17TH ST STE 2800SOUTH
 DENVER, CO 80202-5402 US

LINE #	QTY	DESCRIPTION	REMARKS	UNIT PRICE	TOTAL
1	11.00	LOCATABLE MINERALS / MINING CLAIMS- NEW, UNADJUD, ONE OR MORE AUTH NOS / NEW MINING CLAIM PROCESSING FEE \$15 CASES: AMC413450/\$15.00, AMC413451/\$15.00, AMC413452/\$15.00, AMC413453/\$15.00, AMC413454/ \$15.00, AMC413455/\$15.00, AMC413456/\$15.00, AMC413457/\$15.00, AMC413458/\$15.00, AMC413459/ \$15.00, AMC413460/\$15.00		- n/a -	165.00
2	11.00	LOCATABLE MINERALS / MINING CLAIMS- NEW, UNADJUD, ONE OR MORE AUTH NOS / NEW MINING CLAIM LOCATION FEE \$34 CASES: AMC413450/\$34.00, AMC413451/\$34.00, AMC413452/\$34.00, AMC413453/\$34.00, AMC413454/ \$34.00, AMC413455/\$34.00, AMC413456/\$34.00, AMC413457/\$34.00, AMC413458/\$34.00, AMC413459/ \$34.00, AMC413460/\$34.00		- n/a -	374.00
3	11.00	LOCATABLE MINERALS / MINING CLAIMS- NEW, UNADJUD, ONE OR MORE AUTH NOS / NEW MINING CLAIM MAINT FEE \$140 CASES: AMC413450/\$140.00, AMC413451/\$140.00, AMC413452/\$140.00, AMC413453/\$140.00, AMC413454/ \$140.00, AMC413455/\$140.00, AMC413456/\$140.00, AMC413457/\$140.00, AMC413458/\$140.00, AMC413459/ \$140.00, AMC413460/\$140.00		- n/a -	1540.00
TOTAL:					\$2,079.00

PAYMENT INFORMATION

1	AMOUNT:	2079.00	POSTMARKED:	01/10/2012
	TYPE:	CHECK	RECEIVED:	01/17/2012
	CHECK NO:	1395		

NAME:	GOOD EARTH MINERALS LLC 600 17TH ST STE 2800SOUTH DENVER CO 80202-5402 US
-------	---

REMARKS

This receipt was generated by the automated BLM Collections and Billing System and is a paper representation of a portion of the official electronic record contained therein.

NOTICE!!

These documents have been scanned!

Do not place un-scanned documents beneath this notice!

Do not remove this notice from this file!

GPO Jacket No. 560-102
Print Order 61540
Rise Business Services, LLC
Job=AZ15 5/15/2019



Box Number= AZ15052



Claim Begin-End: AMC413450-AMC413460

2 Correspondence



AZ15052-5

AMC413297-AMC418724

**NO
DOCUMENTS
FOUND**

NO DOCUMENTS FOUND
NO DOCUMENTS FOUND

NOTICE!!

These documents have been scanned!

Do not place un-scanned documents beneath this notice!

Do not remove this notice from this file!

GPO Jacket No. 560-102
Print Order 61540
Rise Business Services, LLC
Job=AZ15 5/15/2019



Box Number= AZ15052



Claim Begin-End: AMC413450-AMC413460

3 Transfers



AZ15052-5

AMC413297-AMC418724

**NO
DOCUMENTS
FOUND**

NO DOCUMENTS FOUND
NO DOCUMENTS FOUND

NOTICE!!

These documents have been scanned!

Do not place un-scanned documents beneath this notice!

Do not remove this notice from this file!

GPO Jacket No. 560-102
Print Order 61540
Rise Business Services, LLC
Job=AZ15 5/15/2019



Box Number= AZ15052



Claim Begin-End: AMC413450-AMC413460

4 Miscellaneous



AZ15052-5

AMC413297-AMC418724

**NO
DOCUMENTS
FOUND**

NO DOCUMENTS FOUND
NO DOCUMENTS FOUND

NOTICE!!

These documents have been scanned!

Do not place un-scanned documents beneath this notice!

Do not remove this notice from this file!

GPO Jacket No. 560-102
Print Order 61540
Rise Business Services, LLC
Job=AZ15 5/15/2019



Box Number= AZ15052



Claim Begin-End: AMC413450-AMC413460

5 Annual Filings



AZ15052-5

AMC413297-AMC418724

UNITED STATES
DEPARTMENT OF THE INTERIOR
BUREAU OF LAND MANAGEMENT
**MAINTENANCE FEE PAYMENT FORM FOR
LODE CLAIMS, MILL SITES, AND TUNNEL SITES**

AMC 413442
413450
430859

Remitter Name: Good Earth Minerals, LLC
Mailing Address: 600 17th Street, Suite 2800 South
City, State, Zip: Denver, CO 80202-5428

☐ Check here if this is a change of address.

FOR COUNTY RECORDER'S USE

No. of claims/sites 45
x \$155 per claim/site
Total due BLM \$ 6975

1. The maintenance fee may be paid by cash, check, money order, Bureau of Land Management (BLM) Declining Deposit Account, or credit card (VISA, American Express, Discover, or MasterCard). Payments must be remitted to the BLM State Office where your claim or site is recorded and received on or before September 1. If the payment is mailed, the envelope must be postmarked by a bona fide delivery service on or before September 1 and received at the proper BLM State Office within 15 calendar days after the due date. Payments may also be made by telephone using a credit card. A complete listing of BLM State Offices with their addresses and phone numbers can be found at <http://www.blm.gov>.
2. The maintenance fee for the following claim(s)/site(s) applies to the assessment year 2014.

CLAIM/SITE NAME	BLM SERIAL NO.
CLAIMANT: GEM CAL LLC	
GEMAE 1	AMC413442
GEMAE 2	AMC413443
GEMAE 3	AMC413444
GEMAE 4	AMC413445
GEMAE 5	AMC413446
GEMAE 6	AMC413447
GEMAE 7	AMC413448
GEMAE 8	AMC413449

Use a separate sheet for additional claim/site names, serial numbers, and claimant names and addresses.

(Continued on page 2)

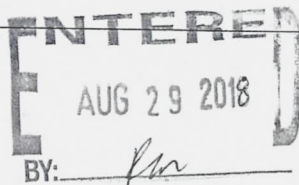

4245716

PAGE 2

Remitter Name: Good Earth Minerals, LLC
Mailing Address: 600 17th Street, Suite 2800 South
City, State, Zip: Denver, CO 80202-5428

CLAIMANT: GEM SUN LLC

CLAIM/SITE NAME	BLM SERIAL NO.
GEM SUN 1	AMC413450
GEM SUN 2	AMC413451
GEM SUN 3	AMC413452
GEM SUN 4	AMC413453
GEM SUN 5	AMC413454
GEM SUN 6	AMC413455
GEM SUN 7	AMC413456
GEM SUN 8	AMC413457
GEM SUN 9	AMC413458
GEM SUN 10	AMC413459
GEM SUN 11	AMC413460
GEM SUN 12	AMC430859
GEM SUN 13	AMC430860
GEM SUN 14	AMC430861
GEM SUN 15	AMC430862
GEM SUN 16	AMC430863
GEM SUN 17	AMC430864
GEM SUN 18	AMC430865
GEM SUN 19	AMC430866
GEM SUN 20	AMC430867
GEM SUN 21	AMC430868
GEM SUN 22	AMC430869
GEM SUN 23	AMC430870
GEM SUN 24	AMC430871
GEM SUN 25	AMC430872

RECEIVED
BLM AZ STATE OFFICE
2010 AUG 24 AM 10:49
PHOENIX, ARIZONA

PAGE 3

Remitter Name: Good Earth Minerals, LLC
Mailing Address: 600 17th Street, Suite 2800 South
City, State, Zip: Denver, CO 80202-5428

CLAIMANT: GEM SUN LLC

CLAIM/SITE NAME BLM SERIAL NO.

GEM SUN 26	AMC430873
GEM SUN 27	AMC430874
GEM SUN 28	AMC430875
GEM SUN 29	AMC430876
GEM SUN 30	AMC430877
GEM SUN 31	AMC430878
GEM SUN 32	AMC430879
GEM SUN 33	AMC430880
GEM SUN 34	AMC430881
GEM SUN 35	AMC430882
GEM SUN 36	AMC430883
GEM SUN 37	AMC430884

RECEIVED
BLM AZ STATE OFFICE
2018 AUG 24 A 10:49
PHOENIX, ARIZONA

INSTRUCTIONS

1. This is an optional form that may be used to satisfy the requirements for the Bureau of Land Management (BLM) under the provisions of 43 U.S.C. §1744 and 30 U.S.C. §28f and the regulations thereunder (43 CFR part 3834). Since local and State laws may vary, you should contact your local and State agencies where the claims are located to ensure all applicable laws and requirements are satisfied.
2. This form should be used to pay the maintenance fee for lode mining claims, mill sites, and tunnel sites only. To pay the maintenance fee for placer mining claims, use Form 3830-5a.
3. Complete the section for the number of claims and the amount being remitted to the BLM.
4. Enter the year in paragraph 2 for the applicable assessment year.
5. List all mining claim or site names and the BLM serial number associated to the claim or site, if the BLM has notified you what the serial number is. Every attempt should be made to include the current BLM serial number for each claim or site listed.
6. The name and current mailing addresses of the person paying the maintenance fee(s) should be listed at the top of the form. If this is a change of address for a claimant, that should also be noted.
7. If needed, an additional sheet can be used to continue listing claim and site names and BLM serial numbers, or the name and current mailing address of additional claimants.
8. If paying by credit card, you must complete the following credit card information on page 3: (a) exact name on the face of the credit card; (b) amount paid; (c) type of card; (d) credit card number; (e) expiration date of the card; and (f) telephone number. You must also sign on page 3 to show authorization to charge the credit card.

NOTICES

THE PRIVACY ACT and 43 CFR 2.48(d) require that you be furnished with the following information in connection with the information requested by this form.

AUTHORITY: 30 U.S.C. 28f and 43 CFR part 3834 permit collection of the information requested by this form.

PRINCIPAL PURPOSE: The BLM will use the information you provide to record the annual maintenance fee payment for the claims and sites listed and to verify that payment has been made in accordance with 30 U.S.C. 28f and 43 CFR part 3834.

ROUTINE USES: The BLM will only disclose this information in accordance with the provisions at 43 CFR 2.56(b) and (c).

EFFECT OF NOT PROVIDING INFORMATION: Disclosure of the requested information is required by 30 U.S.C. 28f and 43 CFR part 3834 for claimants paying the annual maintenance fee. The use of this specific form when paying the maintenance fee is optional. However, when paying the maintenance fee, it is the requested information on this form that is required to be submitted along with the fee. Failure to submit all the required information will delay the BLM's processing of the information and may preclude the BLM's acceptance of the maintenance fee payment, which may result in forfeiture of the mining claim(s) or site(s) by the claimant.

RECEIVED
BLM AZ STATE OFFICE
2018 AUG 24 A 10:49
PHOENIX, ARIZONA

FedEx[®] Express

RECEIVED
BLM AZ STATE OFFICE
2010 AUG 24 A 10:49
PHOENIX, ARIZONA

Helping the environment.

When you use envelopes that are part of
FedEx carbon-neutral envelope
program, you're helping support
projects like wind farms and
investments in these
to live the carbon
all at no extra cost
breathe fresh air.

See how it connects the world in
responsible, resourceful ways at
earthsmart.fedex.com. Join our efforts
by recycling this envelope.



ORIGIN ID:TADA (303) 804-0100
GOOD EARTH MINERALS LLC
600 17TH ST
STE 2800 SOUTH
DENVER, CO 80202
UNITED STATES US

SHI
ACT
CAD
D
16:30
08:24
BILL CREDIT CARD

TO ATTN MINING
BLM AZSO
1 N CENTRAL AVE STE 800

PHOENIX AZ 85004

(602) 417-9200

REF:

NO:

DEPT:

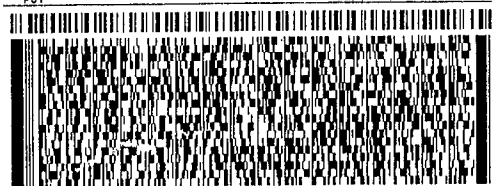

FedEx
Express



REL#
3785346

TRK# 7824 1224 8530
0201

FRI - 24 AUG 4:30P
EXPRESS SAVER

SH ZSYA

85004
AZ-US PHX



ST 5.2
RT 278

57-535 P208 07/13

Print shipping
document here.

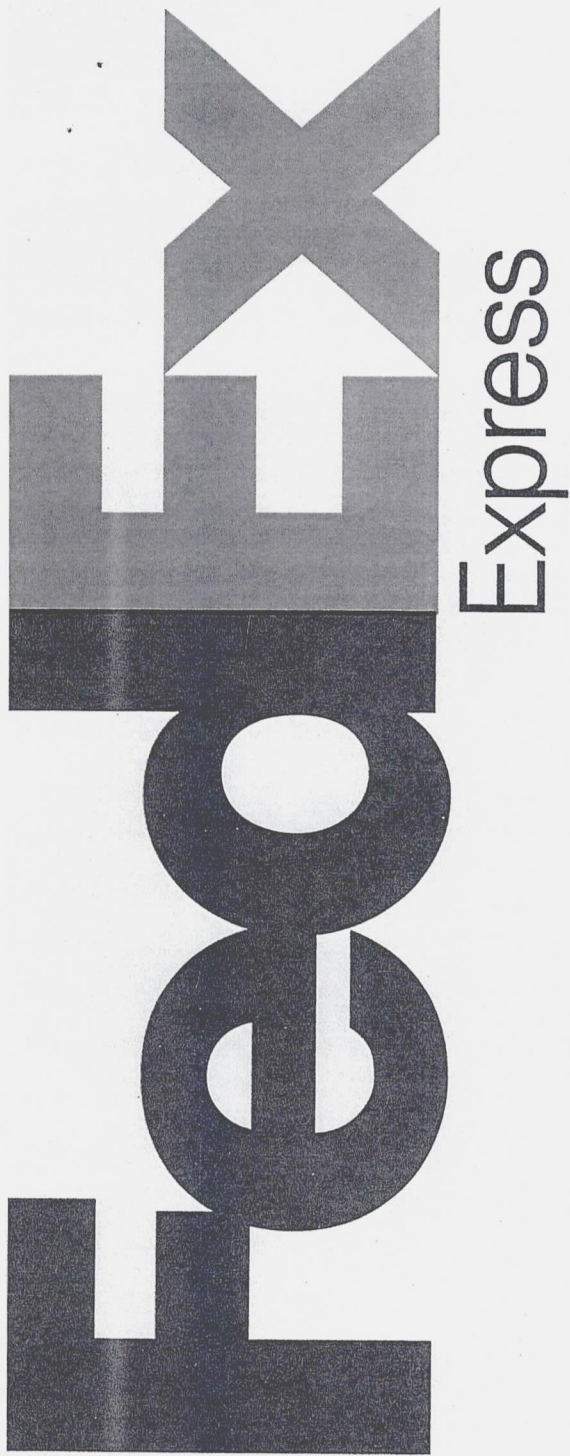

earthsmart
FedEx carbon-neutral
envelope shipping

ORIGIN ID:TADA (303) 804-0100

GOOD EARTH MINERALS LLC
600 17TH ST
STE 2800 SOUTH
DENVER, CO 80202
UNITED STATES US

SHIP DATE: 21AUG18
ACTWGT: 0.20 LB
CAD: 6992635/SSF01904

BILL CREDIT CARD

TO **ATTN MINING**
BLM AZSO
1 N CENTRAL AVE STE 800

PHOENIX AZ 85004

(602) 417-9200
THU:
PO:

REF:

DEPT:

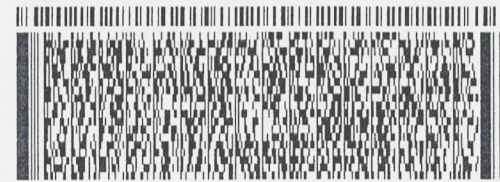

FedEx
Express



REL/
3785346

TRK# 7824 1224 8530
0201

FRI - 24 AUG 4:30P
EXPRESS SAVER

SH ZSYA

85004
AZ-US PHX

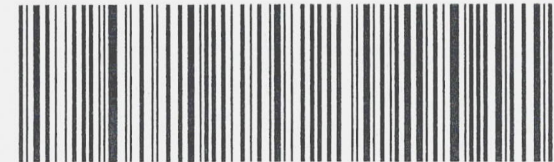

Page 1 of 1
180331-23 180331-23 180331-23 180331-23

United States Department of the Interior
Bureau of Land Management
 DIV OF LANDS, MINRLS & ENERGY
 ONE N CENTRAL AVE
 PHOENIX, AZ 85004 -4427
 Phone: 602-417-9200

Receipt

No: 4245716

Transaction #: 4361166	
Date of Transaction: 08/27/2018	
CUSTOMER:	
GOOD EARTH MINERALS LLC 600 17TH ST SUITE 2800 SOUTH DENVER, CO 80202-5402 US	

LINE #	QTY	DESCRIPTION	REMARKS	UNIT PRICE	TOTAL
1	1.00	LOCATABLE MINERALS / MINING CLAIMS- NOT NEW-UNADJUD, ONE AUTH NO. ONLY / MINING CLAIM MONEY RECEIVED CASES: AMC413442/\$6975.00	MAINT 2019/45	- n/a -	6975.00
TOTAL:					\$6,975.00

PAYMENT INFORMATION			
NOTE: Items will appear on credit card statement as "Bureau of Land Mgmt CO".			
1	AMOUNT:	6975.00	POSTMARKED: N/A
	TYPE:	CREDIT CARD	RECEIVED: 08/27/2018
	NAME:	GOOD EARTH MINERALS LLC 600 17TH ST SUITE 2800 SOUTH DENVER CO 80202-5402 US	
	CARD NO:	XXXXXXXXXXXX1005	AUTH CODE: 140097
	NAME ON CARD:	JOHN J GRACE	
	SIGNATURE:		

REMARKS

This receipt was generated by the automated BLM Collections and Billing System and is a paper representation of a portion of the official electronic record contained therein.

UNITED STATES
DEPARTMENT OF THE INTERIOR
BUREAU OF LAND MANAGEMENT
**MAINTENANCE FEE PAYMENT FORM FOR
LODE CLAIMS, MILL SITES, AND TUNNEL SITES**

413442
413450
430859

Remitter Name: Good Earth Minerals, LLC
Mailing Address: 600 17th Street, Suite 2800 South
City, State, Zip: Denver, CO 80202-5428

☐ Check here if this is a change of address.

FOR COUNTY RECORDER'S USE

No. of claims/sites 45
x \$155 per claim/site
Total due BLM \$ 6975

1. The maintenance fee may be paid by cash, check, money order, Bureau of Land Management (BLM) Declining Deposit Account, or credit card (VISA, American Express, Discover, or MasterCard). Payments must be remitted to the BLM State Office where your claim or site is recorded and received on or before September 1. If the payment is mailed, the envelope must be postmarked by a bona fide delivery service on or before September 1 and received at the proper BLM State Office within 15 calendar days after the due date. Payments may also be made by telephone using a credit card. A complete listing of BLM State Offices with their addresses and phone numbers can be found at <http://www.blm.gov>.
2. The maintenance fee for the following claim(s)/site(s) applies to the assessment year 2018.

CLAIM/SITE NAME	BLM SERIAL NO.
CLAIMANT: GEM CAL LLC	
GEMAE 1	AMC413442 7
GEMAE 2	AMC413443
GEMAE 3	AMC413444
GEMAE 4	AMC413445
GEMAE 5	AMC413446
GEMAE 6	AMC413447
GEMAE 7	AMC413448
GEMAE 8	AMC413449

Use a separate sheet for additional claim/site names, serial numbers, and claimant names and addresses.

(Continued on page 2)

ENTERED
JUL 27 2017
BY: Rutan

RECEIVED
JUL 27 2017 P 2:50
BLM X. ANZUMA

3905949

PAGE 2

Remitter Name: Good Earth Minerals, LLC
Mailing Address: 600 17th Street, Suite 2800 South
City, State, Zip: Denver, CO 80202-5428

CLAIMANT: GEM SUN LLC

CLAIM/SITE NAME	BLM SERIAL NO.
GEM SUN 1	AMC413450 7
GEM SUN 2	AMC413451
GEM SUN 3	AMC413452
GEM SUN 4	AMC413453
GEM SUN 5	AMC413454
GEM SUN 6	AMC413455
GEM SUN 7	AMC413456
GEM SUN 8	AMC413457
GEM SUN 9	AMC413458
GEM SUN 10	AMC413459
GEM SUN 11	AMC413460 J
GEM SUN 12	AMC430859 7
GEM SUN 13	AMC430860
GEM SUN 14	AMC430861
GEM SUN 15	AMC430862
GEM SUN 16	AMC430863
GEM SUN 17	AMC430864
GEM SUN 18	AMC430865
GEM SUN 19	AMC430866
GEM SUN 20	AMC430867
GEM SUN 21	AMC430868
GEM SUN 22	AMC430869
GEM SUN 23	AMC430870
GEM SUN 24	AMC430871
GEM SUN 25	AMC430872 J

RECEIVED
2017 JUL 24 P 2:56
TUCSON, ARIZONA

PAGE 3

Remitter Name: Good Earth Minerals, LLC
Mailing Address: 600 17th Street, Suite 2800 South
City, State, Zip: Denver, CO 80202-5428

CLAIMANT: GEM SUN LLC

CLAIM/SITE NAME BLM SERIAL NO.

GEM SUN 26	AMC430873
GEM SUN 27	AMC430874
GEM SUN 28	AMC430875
GEM SUN 29	AMC430876
GEM SUN 30	AMC430877
GEM SUN 31	AMC430878
GEM SUN 32	AMC430879
GEM SUN 33	AMC430880
GEM SUN 34	AMC430881
GEM SUN 35	AMC430882
GEM SUN 36	AMC430883
GEM SUN 37	AMC430884

RECEIVED
2017 JUL 24 P 2:56
PHOENIX, ARIZONA

Good Earth Minerals, LLC
600 17th St., Suite 2800 South
Denver, CO 80202-5428

BLM RECEIVED
2017 JUL 24 P 2:55
PHOENIX, ARIZONA

CERTIFIED MAIL



7012 2920 0001 7897 0399

CPU



U.S. POSTAGE
\$3.84
FCML 0000
Orig: 80120
Dest: 85004
07/21/17
11144672
R2305P150710
06 2S

BLM AZSO / Attn: Mining
One North Central Avenue, Ste 800
Phoenix, AZ 85004-4427

85004-442700



United States Department of the Interior
Bureau of Land Management
 DIV OF LANDS, MINRLS & ENERGY
 ONE N CENTRAL AVE
 PHOENIX, AZ 85004 -4427
 Phone: 602-417-9200

Receipt

No: 3905949

Transaction #: 4015327	
Date of Transaction: 07/26/2017	
CUSTOMER:	
GOOD EARTH MINERALS LLC 600 17TH ST SUITE 2800 SOUTH DENVER, CO 80202-5402 US	

LINE #	QTY	DESCRIPTION	REMARKS	UNIT PRICE	TOTAL
1	1.00	LOCATABLE MINERALS / MINING CLAIMS- NOT NEW-UNADJUD, ONE AUTH NO. ONLY / MINING CLAIM MONEY RECEIVED CASES: AMC413442/\$6975.00	MAINT 2018/45	- n/a -	6975.00
TOTAL:					\$6,975.00

PAYMENT INFORMATION			
1	AMOUNT:	6975.00	POSTMARKED: 07/21/2017
	TYPE:	CHECK	RECEIVED: 07/24/2017
	CHECK NO:	5289	
	NAME:	GOOD EARTH MINERALS 600 17TH ST SUITE 2800 SOUTH DENVER CO 80202-5402 US	

REMARKS

This receipt was generated by the automated BLM Collections and Billing System and is a paper representation of a portion of the official electronic record contained therein.

UNITED STATES
DEPARTMENT OF THE INTERIOR
BUREAU OF LAND MANAGEMENT
**MAINTENANCE FEE PAYMENT FORM FOR
LODE CLAIMS, MILL SITES, AND TUNNEL SITES**

413442

413450

408 430859

Remitter Name: Good Earth Minerals, LLC
Mailing Address: 600 17th Street, Suite 2800 South
City, State, Zip: Denver, CO 80202-5428

☐ Check here if this is a change of address.

FOR COUNTY RECORDER'S USENo. of claims/sites 45

x \$155 per claim/site

Total due BLM \$ 6975

- The maintenance fee may be paid by cash, check, money order, Bureau of Land Management (BLM) Declining Deposit Account, or credit card (VISA, American Express, Discover, or MasterCard). Payments must be remitted to the BLM State Office where your claim or site is recorded and received on or before September 1. If the payment is mailed, the envelope must be postmarked by a bona fide delivery service on or before September 1 and received at the proper BLM State Office within 15 calendar days after the due date. Payments may also be made by telephone using a credit card. A complete listing of BLM State Offices with their addresses and phone numbers can be found at <http://www.blm.gov>.
- The maintenance fee for the following claim(s)/site(s) applies to the assessment year 2017.

CLAIM/SITE NAME		BLM SERIAL NO.
CLAIMANT: GEM CAL LLC		
RECEIVED BLM AZ STATE OFFICE 2016 SEP -1 P 3:06 PHOENIX, ARIZONA	GEMAE 1	AMC413442
	GEMAE 2	AMC413443
	GEMAE 3	AMC413444
	GEMAE 4	AMC413445
	GEMAE 5	AMC413446
	GEMAE 6	AMC413447
	GEMAE 7	AMC413448
	GEMAE 8	AMC413449

Use a separate sheet for additional claim/site names, serial numbers, and claimant names and addresses.

(Continued on page 2)

SEP 06 2016

RECEIPT # 3650816

Ram

PAGE 2

RECEIVED
BLM AZ STATE OFFICE

Remitter Name: Good Earth Minerals, LLC
Mailing Address: 600 17th Street, Suite 2800 South
City, State, Zip: Denver, CO 80202-5428

2011 SEP -1 P 3:06
PHOENIX, ARIZONA

CLAIMANT: GEM SUN LLC

CLAIM/SITE NAME	BLM SERIAL NO.
GEM SUN 1	AMC413450 7
GEM SUN 2	AMC413451
GEM SUN 3	AMC413452
GEM SUN 4	AMC413453
GEM SUN 5	AMC413454
GEM SUN 6	AMC413455
GEM SUN 7	AMC413456
GEM SUN 8	AMC413457
GEM SUN 9	AMC413458
GEM SUN 10	AMC413459
GEM SUN 11	AMC413460 J
GEM SUN 12	AMC430859 7
GEM SUN 13	AMC430860
GEM SUN 14	AMC430861
GEM SUN 15	AMC430862
GEM SUN 16	AMC430863
GEM SUN 17	AMC430864
GEM SUN 18	AMC430865
GEM SUN 19	AMC430866
GEM SUN 20	AMC430867
GEM SUN 21	AMC430868
GEM SUN 22	AMC430869
GEM SUN 23	AMC430870
GEM SUN 24	AMC430871
GEM SUN 25	AMC430872 J

PAGE 3

Remitter Name: Good Earth Minerals, LLC

Mailing Address: 600 17th Street, Suite 2800 South

City, State, Zip: Denver, CO 80202-5428

RECEIVED
BLM AZ STATE OFFICE

SEP - 1 P 3:06

PHOENIX, ARIZONA

CLAIMANT: GEM SUN LLC

CLAIM/SITE NAME	BLM SERIAL NO.
------------------------	-----------------------

GEM SUN 26	AMC430873
GEM SUN 27	AMC430874
GEM SUN 28	AMC430875
GEM SUN 29	AMC430876
GEM SUN 30	AMC430877
GEM SUN 31	AMC430878
GEM SUN 32	AMC430879
GEM SUN 33	AMC430880
GEM SUN 34	AMC430881
GEM SUN 35	AMC430882
GEM SUN 36	AMC430883
GEM SUN 37	AMC430884

Flat Rate Envelope

Flat Rate postage regardless of weight, destination, or type of mail

Go to www.usps.com/postageonline



EXPECTED DELIVERY DAY: 09/01/2016

USPS TRACKING NUMBER



9505 5213 6511 6243 0003 36

PLI

CPU U.S. POSTAGE

PB 1P 000
3658221
PRFL
0006

MAILED AUG 30 2016
80120

\$ 6.45⁰



www.usps.com

**TRY FREE
CARRIER PICK-UP**
usps.com/pickup

From: Good Earth Minerals, LLC
600 17th St., Suite 2800 South
Denver, CO 80202-5428

To:
BLM AZSO / Attn: Mining
One North Central Avenue, Ste 800
Phoenix, AZ 85004-4427

RECEIVED
BLM AZ STATE OFFICE
2016 SEP - 1 P 3:06
PHOENIX, ARIZONA

HOW TO USE:



1. COMPLETE ADDRESS AREA
Type or print return address and

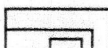

2. PAYMENT METHOD
Affix postage or meter strip to area

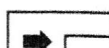

3. ATTACH LABEL (Optional)
Remove label backing and



4. Bring your Priority Mail package to
a post office, present it to your letter carrier,

We Deliver.

This packaging is the property of the U.S. Postal Service ® and is provided solely for use in sending Priority Mail ®.
Misuse may be a violation of federal law. © EP14F January 2006 USPS ALL RIGHTS RESERVED

Any amount of mailable material may be enclosed, as long as the envelope is not modified, and the contents are entirely confined within the envelope with the adhesive provided as the means of closure. Domestic use only.

United States Department of the Interior
Bureau of Land Management
DIV OF LANDS, MINRLS & ENERGY
ONE N CENTRAL AVE
PHOENIX, AZ 85004 -4427
Phone: 602-417-9200

Receipt

No: 3650816

Transaction #: 3754840	
Date of Transaction: 09/02/2016	
CUSTOMER:	
	GOOD EARTH MINERALS LLC 600 17TH ST SUITE 2800 SOUTH DENVER, CO 80202-5402 US

LINE #	QTY	DESCRIPTION	REMARKS	UNIT PRICE	TOTAL
1	1.00	LOCATABLE MINERALS / MINING CLAIMS- NOT NEW-UNADJUD, ONE AUTH NO. ONLY / MINING CLAIM MONEY RECEIVED CASES: AMC413442/\$6975.00	MAINT FEE 2017 - 45	- n/a -	6975.00
TOTAL:					\$6,975.00

PAYMENT INFORMATION				
NOTE: Items will appear on credit card statement as "Bureau of Land Mgmt CO".				
1	AMOUNT:	6975.00	POSTMARKED:	N/A
	TYPE:	CREDIT CARD	RECEIVED:	09/01/2016
	NAME:	JONES, JANICE 600 17TH ST SUITE 2800 SOUTH DENVER CO 80202-5402 US		
	CARD NO:	XXXXXXXXXXXX5014	AUTH CODE:	107694
	NAME ON CARD:	JANICE JONES		
	EXPIRES:	07/2020		
	SIGNATURE:			

REMARKS

This receipt was generated by the automated BLM Collections and Billing System and is a paper representation of a portion of the official electronic record contained therein.

UNITED STATES
DEPARTMENT OF THE INTERIOR
BUREAU OF LAND MANAGEMENT
**MAINTENANCE FEE PAYMENT FORM FOR
LODE CLAIMS, MILL SITES, AND TUNNEL SITES**

413442
413450
430859

Remitter Name: Good Earth Minerals, LLC
Mailing Address: 600 17th Street, Suite 2800 South
City, State, Zip: Denver, CO 80202-5428

☐ Check here if this is a change of address.

FOR COUNTY RECORDER'S USE

No. of claims/sites 45
x \$155 per claim/site
Total due BLM \$ 6975

1. The maintenance fee may be paid by cash, check, money order, Bureau of Land Management (BLM) Declining Deposit Account, or credit card (VISA, American Express, Discover, or MasterCard). Payments must be remitted to the BLM State Office where your claim or site is recorded and received on or before September 1. If the payment is mailed, the envelope must be postmarked by a bona fide delivery service on or before September 1 and received at the proper BLM State Office within 15 calendar days after the due date. Payments may also be made by telephone using a credit card. A complete listing of BLM State Offices with their addresses and phone numbers can be found at <http://www.blm.gov>.
2. The maintenance fee for the following claim(s)/site(s) applies to the assessment year 2016.

CLAIM/SITE NAME	BLM SERIAL NO.
CLAIMANT: GEM CAL LLC	
GEMAE 1	AMC413442
GEMAE 2	AMC413443
GEMAE 3	AMC413444
GEMAE 4	AMC413445
GEMAE 5	AMC413446
GEMAE 6	AMC413447
GEMAE 7	AMC413448
GEMAE 8	AMC413449
NEXT PAGE FOR 2nd CLAIMANT/CLAIM/SITE NAMES	

Use a separate sheet for additional claim/site names, serial numbers, and claimant names and addresses.

(Continued on page 2)

ENTERED
AUG 17 2016
BY: RS

RECEIPT # 3364276

RECEIVED
BLM ARIZONA OFFICE
2016 AUG 10 P 3:31
PHOENIX, ARIZONA

PAGE 2

Remitter Name: Good Earth Minerals, LLC
Mailing Address: 600 17th Street, Suite 2800 South
City, State, Zip: Denver, CO 80202-5428

CLAIMANT: GEM SUN LLC

CLAIM/SITE NAME	BLM SERIAL NO.
GEM SUN 1	AMC413450
GEM SUN 2	AMC413451
GEM SUN 3	AMC413452
GEM SUN 4	AMC413453
GEM SUN 5	AMC413454
GEM SUN 6	AMC413455
GEM SUN 7	AMC413456
GEM SUN 8	AMC413457
GEM SUN 9	AMC413458
GEM SUN 10	AMC413459
GEM SUN 11	AMC413460
GEM SUN 12	AMC430859
GEM SUN 13	AMC430860
GEM SUN 14	AMC430861
GEM SUN 15	AMC430862
GEM SUN 16	AMC430863
GEM SUN 17	AMC430864
GEM SUN 18	AMC430865
GEM SUN 19	AMC430866
GEM SUN 20	AMC430867
GEM SUN 21	AMC430868
GEM SUN 22	AMC430869
GEM SUN 23	AMC430870
GEM SUN 24	AMC430871
GEM SUN 25	AMC430872

RECEIVED
BLM ARIZONA OFFICE
2015 AUG 10 P 3:35
PHOENIX, ARIZONA

PAGE 3

Remitter Name: Good Earth Minerals, LLC
Mailing Address: 600 17th Street, Suite 2800 South
City, State, Zip: Denver, CO 80202-5428

CLAIMANT: GEM SUN LLC

CLAIM/SITE NAME	BLM SERIAL NO.
------------------------	-----------------------

GEM SUN 26	AMC430873
GEM SUN 27	AMC430874
GEM SUN 28	AMC430875
GEM SUN 29	AMC430876
GEM SUN 30	AMC430877
GEM SUN 31	AMC430878
GEM SUN 32	AMC430879
GEM SUN 33	AMC430880
GEM SUN 34	AMC430881
GEM SUN 35	AMC430882
GEM SUN 36	AMC430883
GEM SUN 37	AMC430884

RECEIVED
BLM PHOENIX OFFICE
2015 AUG 10 P 3:35
PHOENIX, ARIZONA

United States Department of the Interior
Bureau of Land Management
 LANDS/RECREATION & PLANNING
 ONE N CENTRAL AVE
 PHOENIX, AZ 85004 -2203
 Phone: 602-417-9200

Receipt

No: 3364276

Transaction #: 3462321**Date of Transaction:** 08/11/2015

CUSTOMER:

GOOD EARTH MINERALS LLC
 600 17TH ST
 SUITE 2800 SOUTH
 DENVER, CO 80202-5402 US

LINE #	QTY	DESCRIPTION	REMARKS	UNIT PRICE	TOTAL
1	1.00	LOCATABLE MINERALS / MINING CLAIMS-NOT NEW-UNADJUD, ONE AUTH NO. ONLY / MINING CLAIM MONEY RECEIVED CASES: AMC413442/\$6975.00	MAINT FEE PYMNT (45) 2016	- n/a -	6975.00
TOTAL:					\$6,975.00

PAYMENT INFORMATION			
1	AMOUNT:	6975.00	POSTMARKED: 08/06/2015
	TYPE:	CHECK	RECEIVED: 08/10/2015
	CHECK NO:	2034	
	NAME:	GOOD EARTH MINERALS LLC 600 17TH ST SUITE 2800 SOUTH DENVER CO 80202-5402 US	

REMARKS

This receipt was generated by the automated BLM Collections and Billing System and is a paper representation of a portion of the official electronic record contained therein.

8/11/2015

Good Earth Minerals, LLC
600 17th St., Suite 2800 South
Denver CO 80202-5428



7013 3020 0001 6185 5998

CPU U.S. POSTAGE

\$ 4.870

PB 1P 000
3658221
FCMF

MAILED AUG 06 2015
80120



RECEIVED
BLM STATE OFFICE
2015 AUG 10 P 3:35
PHOENIX, ARIZONA

BLM - AZSO
Attn: Mining
One North Central Avenue, Suite 800
Phoenix, Arizona 85004-4427

$$\begin{array}{r} 155 \\ 45 \\ \hline 775 \\ 620 \end{array}$$

**DEPARTMENT OF THE INTERIOR
BUREAU OF LAND MANAGEMENT
MINING CLAIMS**

413450

MC Maintenance Fees Paid Through the BLM Pay Portal

CBS Receipt: 3101910

Agency Tracking ID: 1091447303

Assessment Year: 2015

Paid On : 08/14/2014

Number of BLM Serial Nr: 11

Total Amount Paid: \$1,705.00

Claim Name	BLM Serial No	Lead File No	Case Type	Amount Paid
GEM SUN 1	AMC413450	AMC413450	384201	\$155.00
GEM SUN 2	AMC413451			\$155.00
GEM SUN 3	AMC413452			\$155.00
GEM SUN 4	AMC413453			\$155.00
GEM SUN 5	AMC413454			\$155.00
GEM SUN 6	AMC413455			\$155.00
GEM SUN 7	AMC413456			\$155.00
GEM SUN 8	AMC413457			\$155.00
GEM SUN 9	AMC413458			\$155.00
GEM SUN 10	AMC413459			\$155.00
GEM SUN 11	AMC413460			\$155.00

United States Department of the Interior
Bureau of Land Management
BUSINESS & SUPPORT SVCS DIV
ONE N CENTRAL AVE SUITE 800
PHOENIX, AZ 85004 -4427
Phone: (602) 417-9200

Receipt

No: 3101910

Transaction #: 3193473	
Date of Transaction: 08/14/2014	
CUSTOMER:	
	TONY M. HARTMAN 8547 E. ARAPAHOE ROAD GREENWOOD VILLAGE, CO 80112

LINE #	QTY	DESCRIPTION	REMARKS	UNIT PRICE	TOTAL
1	1.00	LOCATABLE MINERALS / MINING CLAIMS- NOT NEW-UNADJUD, ONE AUTH NO. ONLY / MINING CLAIM MONEY RECEIVED CASES: AMC413451/\$1705.00		- n/a -	1705.00
TOTAL:					\$1,705.00

PAYMENT INFORMATION				
NOTE: Items will appear on credit card statement as "BLM O Mining Claim".				
1	AMOUNT:	1705.00	POSTMARKED:	N/A
	TYPE:	CREDIT CARD	RECEIVED:	08/14/2014
	NAME:	TONY M. HARTMAN 8547 E. ARAPAHOE ROAD GREENWOOD VILLAGE CO 80112		
	CARD NO:	XXXXXXXXXXXX8853	AUTH CODE:	05970G
	NAME ON CARD:	TONY M. HARTMAN		
	EXPIRES:	07/2016		
	SIGNATURE:			

REMARKS

This receipt was generated by the automated BLM Collections and Billing System and is a paper representation of a portion of the official electronic record contained therein.

Snell & Wilmer
—L.L.P.—
LAW OFFICES

Gateway Tower West
15 West South Temple
Suite 1200
Salt Lake City, Utah 84101-1531
801.257.1900
801.257.1800 (Fax)
www.swlaw.com

Jennifer Ames
(801) 257-1917
james@swlaw.com

January 27, 2014

VIA FEDERAL EXPRESS

BLM Arizona State Office
One North Central Avenue, Suite 800
Phoenix, Arizona 85004-4427

Dear Sir or Madam:

On behalf of GEM SUN, LLC, we are submitting this Notice of Transfer of Interest pursuant to 43 C.F.R. § 3833.32 for the following unpatented mining claims located in Mohave County, Arizona:

Claim Name/Number	Serial No.	Lead Serial No.
GEM SUN 1	AMC413450	AMC413450
GEM SUN 2	AMC413451	AMC413450
GEM SUN 3	AMC413452	AMC413450
GEM SUN 4	AMC413453	AMC413450
GEM SUN 5	AMC413454	AMC413450
GEM SUN 6	AMC413455	AMC413450
GEM SUN 7	AMC413456	AMC413450
GEM SUN 8	AMC413457	AMC413450
GEM SUN 9	AMC413458	AMC413450
GEM SUN 10	AMC413459	AMC413450
GEM SUN 11	AMC413460	AMC413450

Enclosed is a true and correct copy of the Mining Deed, dated November 29, 2013, from Good Earth Minerals, LLC, conveying title to fifteen unpatented mining claims. Also, enclosed is check #30140 in the amount of \$110 for all fees associated with this submittal. Once you have completed processing this filing, please return a copy and receipt in the enclosed self-addressed, postage prepaid envelope.

If you have any questions concerning this request, please feel free to contact me. Thank you for your assistance.



AMC 413450

DENVER
LAS VEGAS
LOS ANGELES
LOS CABOS
ORANGE COUNTY
PHOENIX
RENO
SALT LAKE CITY
TUCSON

RECEIVED
BLM ARIZONA STATE OFFICE
2014 JAN 28 A 10:28
PHOENIX, ARIZONA

BLM Arizona State Office
January 27, 2014
Page 2

Very truly yours,

SNELL & WILMER

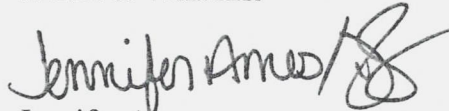
Jennifer Ames

JA/hks

18655361

RECEIVED
BLM AZ STATE OFFICE
2014 JAN 28 A 10:28
BLM AZ STATE OFFICE

When recorded, return to:

James P. Allen, Esq.
Snell & Wilmer L.L.P.
Gateway Tower West
15 West South Temple, Suite 1200
Salt Lake City, Utah 84101-1547

Exempt per A.R.S. § 11-1134(A)(6)

FEE# 2014000573

OFFICIAL RECORDS
OF MOHAVE COUNTY
CAROL MEIER,
COUNTY RECORDER



01/07/2014 11:23 AM Fee: \$10.00

PAGE: 1 of 3

MINING DEED
(With special warranties of possessory title)

FOR GOOD AND VALUABLE CONSIDERATION, the receipt and sufficiency of which are hereby expressly acknowledged, **GOOD EARTH MINERALS, LLC**, a Colorado limited liability company ("Grantor"), hereby conveys to **GEM SUN, LLC**, a Colorado limited liability company, whose address is 600 17th Street, Suite 2800 South, Denver, Colorado, 80202, those certain unpatented lode mining claims situated in Mohave County, Arizona (the "Property"), whose names and serial numbers assigned by the Arizona State Office of the Bureau of Land Management are set forth in Exhibit A attached hereto and made a part hereof.

TOGETHER WITH any and all extralateral and other associated rights, water rights, tenements, hereditaments and appurtenances thereto belonging or otherwise appertaining thereto.

SUBJECT TO:

1. Current and existing taxes, if any, and all other matters of record and such matters as an accurate survey or visual inspection of the Property would disclose;
2. Paramount title of the United States;
3. All existing roads, rights-of-way and easements of record in Mohave County, Arizona, and the Arizona State Office of the Bureau of Land Management;
4. All leases, permits, approvals and other rights heretofore or hereafter granted by the United States in its administration of its paramount title; and
5. The effect of conflicts and overlaps (if any) between the above-described mining claims and adjoining mining claims owned by third parties.

Grantor hereby binds itself and its successors to warrant and defend its possessory title, as against all acts of the Grantor herein and no other, subject to the matters set forth above.

IN WITNESS WHEREOF, Grantor has executed this Mining Deed on the 29th day of November, 2013.

GRANTOR:

GOOD EARTH MINERALS, LLC, a Colorado limited liability company

By: [Signature]

Name: Janice A. Jones

Title: Managing Director

STATE OF COLORADO)

COUNTY OF Douglas) ss

The foregoing instrument was acknowledged before me this 29 day of November, 2013, by Janice A. Jones the Managing Director, of Good Earth Minerals, LLC, a Colorado limited liability company, for and on behalf of the company.

[Signature]
Notary Public

My commission expires:

01-27-2014

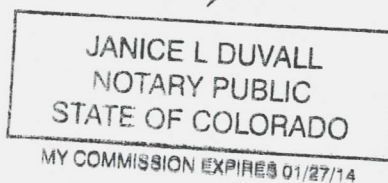

EXHIBIT A

The Property consists of the following described mining claims situated in Sections 2 and 3, Township 41 North, Range 11 West, Gila & Salt River Meridian, Mohave County, Arizona:

Claim Name/Number	Serial No.	Lead Serial No.
GEM SUN 1	AMC413450	AMC413450
GEM SUN 2	AMC413451	AMC413450
GEM SUN 3	AMC413452	AMC413450
GEM SUN 4	AMC413453	AMC413450
GEM SUN 5	AMC413454	AMC413450
GEM SUN 6	AMC413455	AMC413450
GEM SUN 7	AMC413456	AMC413450
GEM SUN 8	AMC413457	AMC413450
GEM SUN 9	AMC413458	AMC413450
GEM SUN 10	AMC413459	AMC413450
GEM SUN 11	AMC413460	AMC413450

RECORDED, ARIZONA

704 JAN 28 A 10:28

11-1-2013 10:28 AM

United States Department of the Interior
Bureau of Land Management
LANDS/RECREATION & PLANNING
ONE N CENTRAL AVE
PHOENIX, AZ 85004 -2203
Phone: 602-417-9200

Receipt

No: 2957458

Transaction #: 3045464	
Date of Transaction: 01/29/2014	
CUSTOMER:	
	SNELL & WILMER LLP 15 W SOUTH TEMPLE STE 1200 SALT LAKE CITY,UT 84101-1547 US

LINE #	QTY	DESCRIPTION	REMARKS	UNIT PRICE	TOTAL
1	1.00	LOCATABLE MINERALS / MINING CLAIMS- NOT NEW-UNADJUD,ONE AUTH NO. ONLY / MINING CLAIM MONEY RECEIVED CASES: AMC413450/\$110.00	TRF - 11	- n/a -	110.00
TOTAL:					\$110.00

PAYMENT INFORMATION				
1	AMOUNT:	110.00	POSTMARKED:	01/27/2014
	TYPE:	CHECK	RECEIVED:	01/28/2014
	CHECK NO:	30140		
	NAME:	SNELL WILMER LLP 15 W SOUTH TEMPLE STE 1200 SALT LAKE CITY UT 84101-1547 US		

REMARKS

This receipt was generated by the automated BLM Collections and Billing System and is a paper representation of a portion of the official electronic record contained therein.

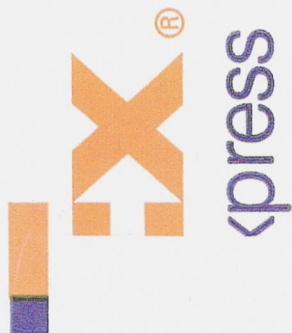

Extremely Urgent

Page 1 of 1

From: (801) 257-1992
Heather Smith
Snell & Wilmer L.L.P.
15 W South Temple Ste 1200
Salt Lake City, UT 84101

Origin ID: NPHA



J14101312270326

SHIP TO: (602) 417-9200
Main Desk
BLM Arizona State Office
One North Central Avenue
Suite 800
PHOENIX, AZ 85004

BILL SENDER

Ship Date: 27JAN14
ActWgt: 1.0 LB
CAD: 1088298/INET3490

Delivery Address Bar Code



Ref # 64908.00001
Invoice #
PO #
Dept #

TUE - 28 JAN 10:30A
PRIORITY OVERNIGHT

TRK# 7977 3719 6464
0201

WP ZSYA

85004
AZ-US
PHX



522G1/D6ECIF220

nts Only

with the container and
arms and conditions and
e applicable Fed
a current

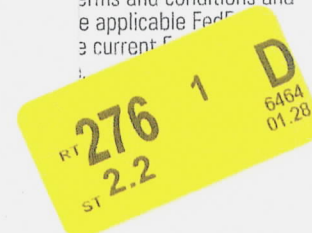

Insert shipping
document here.

**NOTICE OF INTENT TO _____ D
MAINTENANCE FEE
PAYMENT**
(Example Form-Utah)

BLM: One North Central Ave., #800
Phoenix AZ 85004-4427

Reserved for
COUNTY →
RECORDER →
INFO ONLY →
Requires an
original →
document that
is signed and →
notarized.

AMC 4113450

AMC 4113442

Maintenance Fee payment of \$140 per claim/site --pursuant to Regulation 43 CFR 3830.21(d) and 3834.11(a)(2).

(Fee may be paid by cash, check, money order, BLM Declining Deposit Account (DDA), or Visa/Master card payable to the U.S. Department of Interior, Bureau of Land Management (BLM). Submit payment to the above address. Payment must be received on or before September 1 or the envelope must be postmarked by a bona fide mail delivery service on or before September 1 and received within 15 days. The fees may be paid by completing this form and submitting to the BLM by facsimile/fax, (801)539-4237, and then contact the BLM Information Access Center-Accounts at (801)539-4001.
Submit prior to August for a quicker return of receipt.)

*If the maintenance fee was waived in the previous assessment year, you must complete the assessment work for that year and submit POL to BLM.
*Failure to pay maintenance fees or file waiver certification on or before Sept. 1 results in the claim/site being forfeited by operation of law.
*Uncollectible check, financial instrument, and card payment will be deemed as nonpayment of fees and if after due date claim/site forfeited.
*You cannot modify document or pay additional fees after the due date.

MAINTENANCE FEE(S) is paid in advance for the upcoming year 2014, in the amount of \$ 2,660.00 for the following 19 mining claim/site(s):

CLAIM/SITE NAME(S) & UMC NUMBER(S) (please print or type):
CHECK ☒ if a Mill or Tunnel Site(s) listed below.

CHECK ☒ if Continued: ☐ See attached.
☐ See other side.

AMC413442 GEMAE 1	AMC413450 GEM SUN 1
AMC413443 GEMAE 2	AMC413451 GEM SUN 2
AMC413444 GEMAE 3	AMC413452 GEM SUN 3
AMC413445 GEMAE 4	AMC413453 GEM SUN 4
AMC413446 GEMAE 5	AMC413454 GEM SUN 5
AMC413447 GEMAE 6	AMC413455 GEM SUN 6
AMC413448 GEMAE 7	AMC413456 GEM SUN 7
AMC413449 GEMAE 8	AMC413457 GEM SUN 8
	AMC413458 GEM SUN 9
	AMC413459 GEM SUN 10
	AMC413460 GEM SUN 11

RECEIVED
BLM AZ STATE OFFICE
PHOENIX, ARIZONA
2013 AUG 12 PM 2:51

*****FOR BLM USE ONLY*****

PAID for YR 2014 MF

Receipt#

Lead
UMC#

CLAIMANT/REMITTER NAME, MAILING ADDRESS, & TELEPHONE (please print or type):

*THIS ADDRESS will be used to UPDATE the records if it is for the claimant on BLM records.
*If you DO NOT want the BLM to use this address to update the records, please state: "not a change of address".

Good Earth Minerals, LLC
600 17th St., Suite 2800 South
Denver CO 80202-5428
303.804.0100

NO. OF CLAIMS 19

AMOUNT \$2660.00

RECEIPT NO. 2853703

INIT. ACH

** BLM-ASO**

SIGNATURE: [Signature]

DATE: Aug. 6, 2013

The new automated system requires consistent names and address of all the claimants. If possible, PLEASE attach a list showing all the claimants name and mailing address (prefer PO Box) for the claim/site(s) listed above to assure that BLM records reflect the correct name and current address.

CHANGED INTO COMPUTER

AUG 20 2013

United States Department of the Interior
Bureau of Land Management
LANDS/RECREATION & PLANNING
ONE N CENTRAL AVE
PHOENIX, AZ 85004 -2203
Phone: 602-417-9200

Receipt

No: 2853703

Transaction #: 2939481**Date of Transaction:** 08/13/2013**CUSTOMER:**

GOOD EARTH MINERALS LLC
600 17TH ST
SUITE 2800 SOUTH
DENVER, CO 80202-5402 US

LINE #	QTY	DESCRIPTION	REMARKS	UNIT PRICE	TOTAL
1	1.00	LOCATABLE MINERALS / MINING CLAIMS-NOT NEW-UNADJUD, ONE AUTH NO. ONLY / MINING CLAIM MONEY RECEIVED CASES: AMC413442/\$2660.00	MAINT FEE PYMNT (19) 2014 / NOI (19) 2013	- n/a -	2660.00
TOTAL:					\$2,660.00

PAYMENT INFORMATION

1	AMOUNT:	2660.00	POSTMARKED:	08/08/2013
	TYPE:	CHECK	RECEIVED:	08/12/2013
	CHECK NO:	1655		
	NAME:	GOOD EARTH MINERALS LLC 600 17TH ST SUITE 2800 SOUTH DENVER CO 80202-5402 US		

REMARKS

This receipt was generated by the automated BLM Collections and Billing System and is a paper representation of a portion of the official electronic record contained therein.

NOTICE OF INTENT TO MAINTENANCE FEE PAYMENT

(Example Form 1)

BLM: One North Central Ave., #800
Phoenix AZ 85004-4427

10 West 200 South, Suite 500
O. Box 45155
Salt Lake City, UT 84145-0155

Reserved for
COUNTY
RECORDER
INFO ONLY
Requires an
original
document that
is signed and
notarized.

Amc 413442
Amc 413450

Maintenance Fee payment of \$140 per claim/site --pursuant to Regulation 43 CFR 3830.21(d) and 3834.11(a)(2).

(Fee may be paid by cash, check, money order, BLM Declining Deposit Account (DDA), or Visa/Master card payable to the U.S. Department of Interior, Bureau of Land Management (BLM). Submit payment to the above address. Payment must be received on or before September 1 or the envelope must be postmarked by a bona fide mail delivery service on or before September 1 and received within 15 days. The fees may be paid by completing this form and submitting to the BLM by facsimile/fax, (801)539-4237, and then contact the BLM Information Access Center-Accounts at (801)539-4001.
Submit prior to August for a quicker return of receipt.)

*If the maintenance fee was waived in the previous assessment year, you must complete the assessment work for that year and submit POL to BLM.
*Failure to pay maintenance fees or file waiver certification on or before Sept. 1 results in the claim/site being forfeited by operation of law.
*Uncollectible check, financial instrument, and card payment will be deemed as nonpayment of fees and if after due date claim/site forfeited.
*You cannot modify document or pay additional fees after the due date.

MAINTENANCE FEE(S) is paid in advance for the upcoming year 2013, in the amount of \$ \$2,660.00 for the following 19 mining claim/site(s):

CLAIM/SITE NAME(S) & UMC NUMBER(S) (please print or type):
CHECK ☒ if a Mill or Tunnel Site(s) listed below.

CHECK ☒ if Continued: ☐ See attached.
☐ See other side.

AMC413442 GEMA3 1	AMC413450 GEM SUN 1
AMC413443 GEMAE 2	AMC413451 GEM SUN 2
AMC413444 GEMAE 3	AMC413452 GEM SUN 3
AMC413445 GEMAE 4	AMC413453 GEM SUN 4
AMC413446 GEMAE 5	AMC413454 GEM SUN 5
AMC413447 GEMAE 6	AMC413455 GEM SUN 6
AMC413448 GEMAE 7	AMC413456 GEM SUN 7
AMC413449 GEMAE 8	AMC413457 GEM SUN 8
	AMC413458 GEM SUN 9
	AMC413459 GEM SUN 10
	AMC413460 GEM SUN 11

RECEIVED
BLM AZ STATE OFFICE
2012 AUG 20 A 10:24
PHOENIX, ARIZONA

Entered 16 claims
413442-413457
not enough for
last 3 claims. AT
received \$400 9/4/12 AT

ENTERED INTO COMPUTER

9/4/12 AT

*****FOR BLM USE ONLY*****

PAID for YR 2013 MF

Receipt# 2635712

Lead Amc 413442
UMC# 413442

CLAIMANT/REMITTER NAME, MAILING ADDRESS, & TELEPHONE (please print or type):

*THIS ADDRESS will be used to UPDATE the records if it is for the claimant on BLM records.
*If you DO NOT want the BLM to use this address to update the records, please state: "not a change of address".

Good Earth Minerals, LLC
600 17th St., Suite 2800 South
Denver CO 80202-5428
303.804.0100

NO. OF CLAIMS 19

AMOUNT \$2260.00

RECEIPT NO. 2635712

INIT. CA.A.

** BLM-ASO **

SIGNATURE: [Signature] DATE: 8/15/12

The new automated system requires consistent names and address of all the claimants. If possible, PLEASE attach a list showing all the claimants name and mailing address (prefer PO Box) for the claim/site(s) listed above to assure that BLM records reflect the correct name and current address.

ENTERED INTO COMPUTER

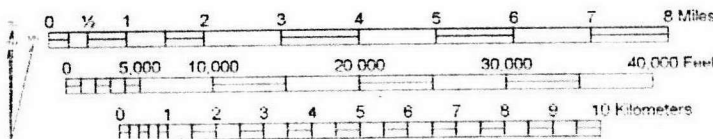
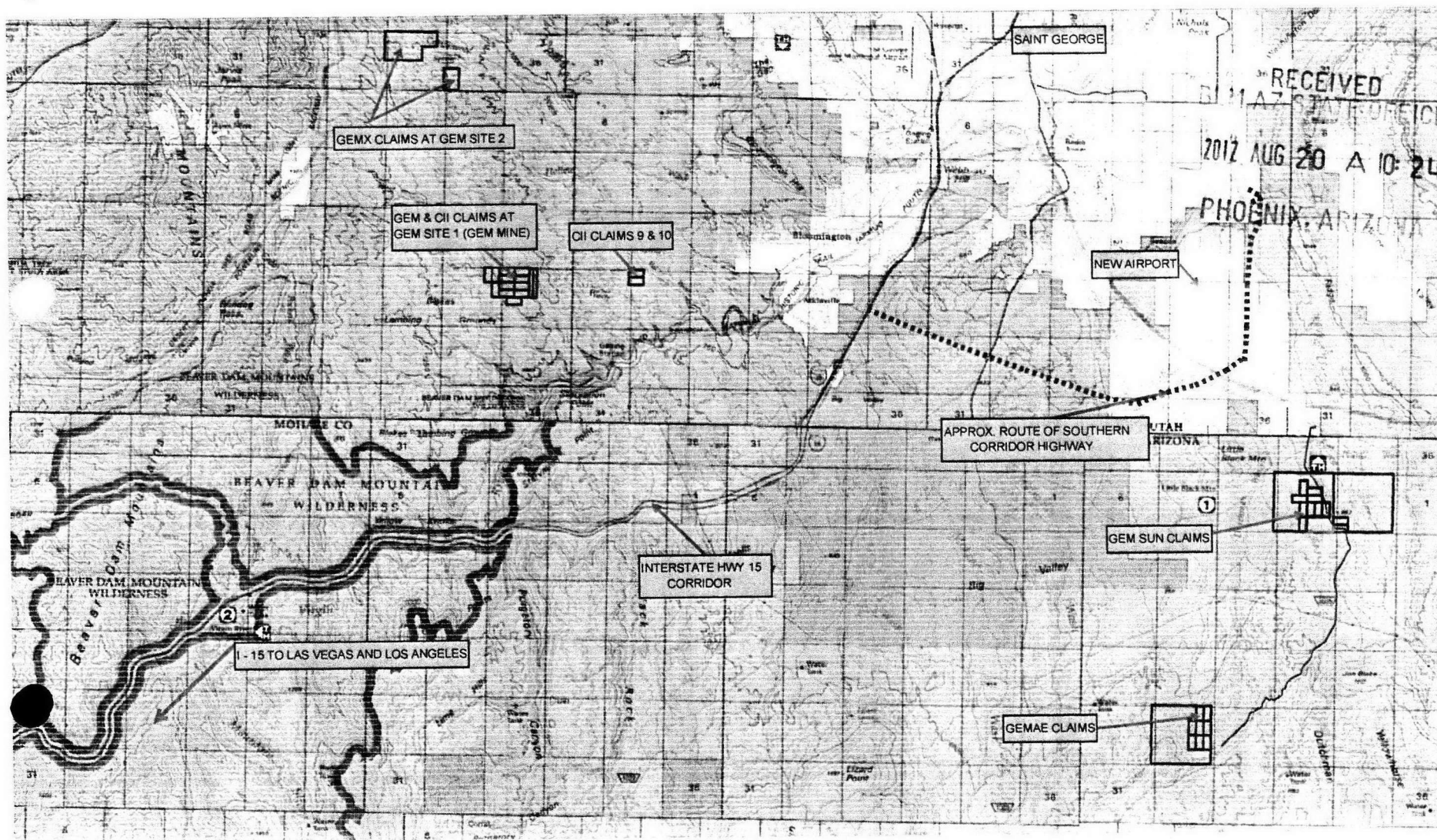

GEM CLAIMS AND MINES 2011

Good Earth Minerals, LLC
600 17th Street, Suite 2800 South
Denver CO 80202-5428

CERTIFIED MAIL™

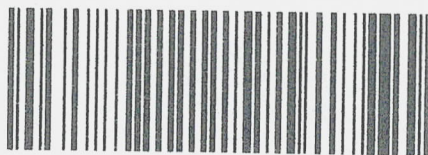

7011 3500 0000 1614 3310

Bureau of Land Management
One North Central Ave., #800
Phoenix AZ 85004-4427



1000



85004

PHOENIX, AZ 85004

AUG 20 A 10:00

RECEIVED
AZ STATE OFFICE

U.S. POSTAGE
PAID
ENGLEWOOD, CO
80113
AUG 15, 12
AMOUNT

\$3.40
00076764-05

85004442700



United States Department of the Interior
Bureau of Land Management
LANDS/RECREATION & PLANNING
ONE N CENTRAL AVE
PHOENIX, AZ 85004 -2203
Phone: 602-417-9200

Receipt

No: 2635712

Transaction #: 2716286	
Date of Transaction: 08/21/2012	
CUSTOMER:	
	GOOD EARTH MINERALS LLC 600 17TH ST SUITE 2800 SOUTH DENVER, CO 80202-5402 US

LINE #	QTY	DESCRIPTION	REMARKS	UNIT PRICE	TOTAL
1	1.00	LOCATABLE MINERALS / MINING CLAIMS-NOT NEW-UNADJUD, ONE AUTH NO. ONLY / MINING CLAIM MONEY RECEIVED CASES: AMC413442/\$2260.00	MAINT FEE PYMNT (19) 2013	- n/a -	2260.00
TOTAL:					\$2,260.00

PAYMENT INFORMATION				
1	AMOUNT:	2260.00	POSTMARKED:	N/A
	TYPE:	CHECK	RECEIVED:	08/21/2012
	CHECK NO:	1507		
	NAME:	GOOD EARTH MINERALS LLC 600 17TH ST SUITE 2800 SOUTH DENVER CO 80202-5402 US		

REMARKS

This receipt was generated by the automated BLM Collections and Billing System and is a paper representation of a portion of the official electronic record contained therein.

United States Department of the Interior
Bureau of Land Management
LANDS/RECREATION & PLANNING
ONE N CENTRAL AVE
PHOENIX, AZ 85004 -2203
Phone: 602-417-9200

Receipt

No:

2649262

Transaction #: 2730055

Date of Transaction: 09/04/2012

CUSTOMER:

GOOD EARTH MINERALS LLC
600 17TH ST
SUITE 2800 SOUTH
DENVER, CO 80202-5402 US

LINE #	QTY	DESCRIPTION	REMARKS	UNIT PRICE	TOTAL
1	1.00	LOCATABLE MINERALS / MINING CLAIMS-NOT NEW-UNADJUD, ONE AUTH NO. ONLY / MINING CLAIM MONEY RECEIVED CASES: AMC413458/\$400.00	MAINT FEE (3) 2013	- n/a -	400.00
TOTAL:					\$400.00

PAYMENT INFORMATION

NOTE: Items will appear on credit card statement as "Bureau of Land Mgmt CO".

1	AMOUNT:	400.00	POSTMARKED:	N/A
	TYPE:	CREDIT CARD	RECEIVED:	09/04/2012
	NAME:	GOOD EARTH MINERALS LLC 600 17TH ST SUITE 2800 SOUTH DENVER CO 80202-5402 US		
	CARD NO:	XXXXXXXXXXXX4574	AUTH CODE:	020084
	NAME ON CARD:	JONES JANICE		
	EXPIRES:	01/2013		
	SIGNATURE:			

REMARKS

ADDITIONAL MONEY FOR ORIGINAL RECEIPT #2635712

This receipt was generated by the automated BLM Collections and Billing System and is a paper representation of a portion of the official electronic record contained therein.

NOTICE!!

These documents have been scanned!

Do not place un-scanned documents beneath this notice!

Do not remove this notice from this file!

GPO Jacket No. 560-102
Print Order 61540
Rise Business Services, LLC
Job=AZ15 5/15/2019



Box Number= AZ15052



Claim Begin-End: AMC413450-AMC413460

6 Location Notices-Amendments and Supporting Documents



AZ15052-5

AMC413297-AMC418724

MINING CLAIM STATUS REPORT

DATA
ENTERED FEB 01 2012 PB

MTP Checked by FEB 01 2012 PB

GEO Checked by FEB 01 2012 PB

LEAD SERIAL NUMBER AMC 413450 thru AMC 413460

OF CLAIMS & TYPE

_____ LODGE
_____ PLACER
11 ASSOCIATION PLACER
_____ MILL SITE
_____ TUNNEL SITE

CHARGES

Location Fee @ \$34 = \$ 374.00
Processing Fee @ \$15 = \$ 165.00
Maintenance Fee @ \$140 = \$ 1540.00
Overage (+) \$
Shortage (-) \$
Other Fees \$

TOTAL \$ 2079.00

ARE THERE ENOUGH LOCATORS?

Yes (X) No ()

DOCUMENTS RECEIVED VIA -

Over-the-Counter () Mail (X)

TIMELY FILED?

Yes (X) No ()

LEGAL DESCRIPTION -

T 41N R 11W SEC 2, 3
T _____ R _____ SEC _____
T _____ R _____ SEC _____
T _____ R _____ SEC _____

BLM () FOREST SERVICE () SUBJ TO PL 359: Yes () No ()

WILDERNESS AREA: No () Yes ()

SPLIT ESTATE - N/A () SX () PX () SRHA () OTHER ()

Proper Notice Filed if Located on SHRA Lands? N/A () Yes () No ()

RECONVEYED MINERALS ON BLM LANDS REQUIRE OPENING ORDERS FROM 1944 TO 1993 -

Open to Entry on: _____ N/A ()

COMMENTS/STATUS - VOID () PARTIALLY VOID () PVT MINERALS () WITHDRAWN LANDS ()

OTHER ()

Claimant acknowledges that portions of the following claims(s) site(s) may be void or voidable.

Printed Name of Claimant _____ Signature of Claimant _____

***** FINAL ADJUDICATION *****

DATE 6/28/2012 INITIALS TS

AMC 413450

MINING CLAIM MAP

Lode () Placer (X)

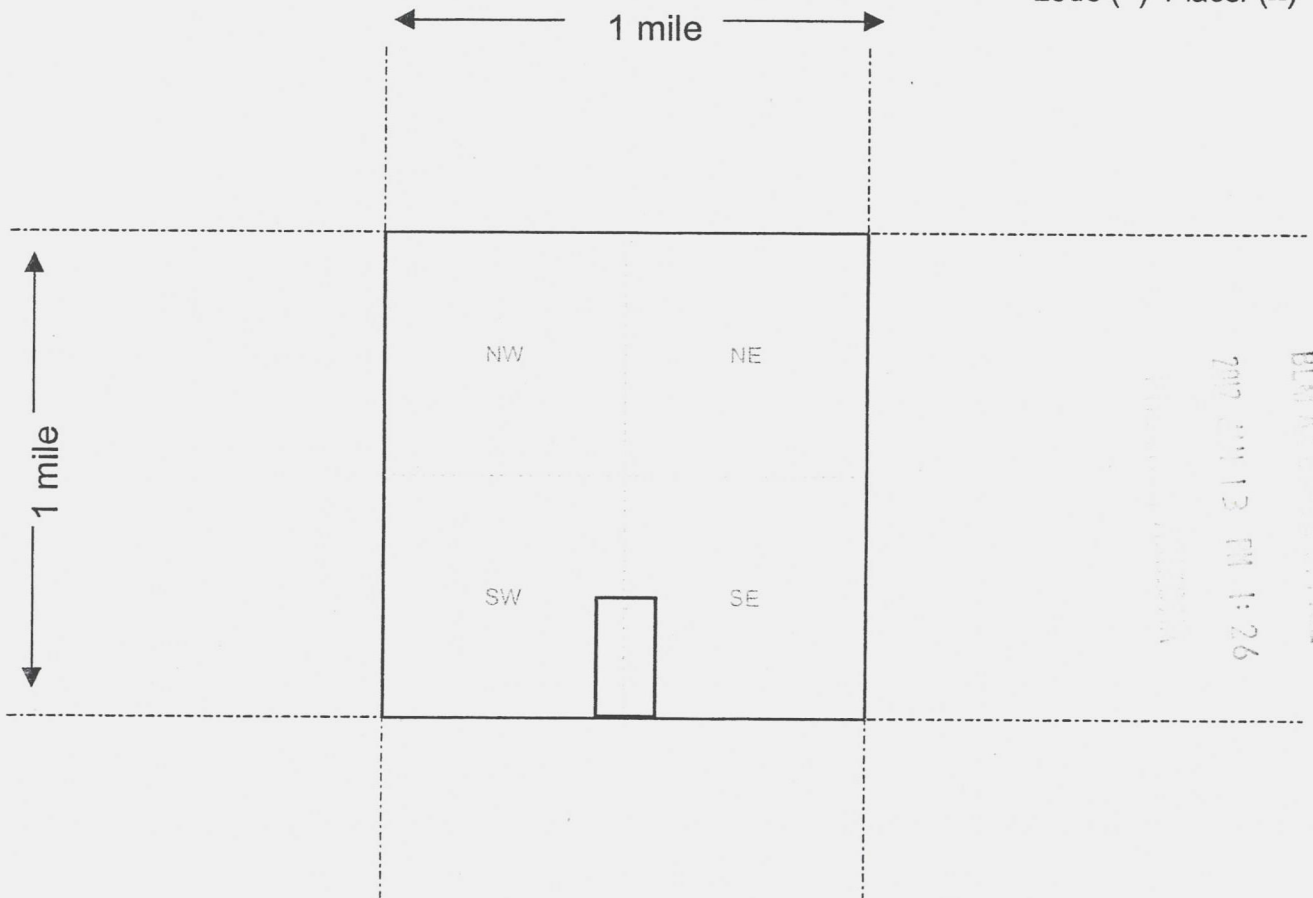

Scale : 1" = 2000 feet



1. The above map depicts the GEM SUN 1 mining claim, which is located in Section (s) 3, Township 41 N, Range 11 W, Gila and Salt River Base and Meridian, Mohave County, Arizona.
2. The type of corner and location monuments used are as follows: Capped 2in.dia.X 5ft. PVC post with a metal tag.
3. The bearings and distances in degrees and feet between claim corners are as depicted on the map.

Form MCF100a
Revised July 2005

This form is available from the Arizona Department of Mines & Mineral Resources and may be reproduced.

AMC413450

UTAH ARIZONA LINE

NORTH

SCALE

0 FEET

1000 FEET

Gravel Pit

Pearce

2856

SECTION 3

SECTION 2

GEM SUN 8

GEM SUN 9

GEM SUN 6

GEM SUN 7

GEM SUN 3

GEM SUN 4

GEM SUN 5

GEM SUN 2

GEM SUN 1

RWB DIXIE BELL 1-4

GEM SUN 11

GEM SUN 10

Prospect

3143x



FEE# 2011062338

OFFICIAL RECORDS
OF MOHAVE COUNTY
CAROL MEIER,
COUNTY RECORDER



12/12/2011 02:23 PM Fee: \$14.00

PAGE: 1 of 2

LOCATION NOTICE FOR PLACER MINING CLAIM

NOTICE IS HEREBY GIVEN that the GEM SUN 2
_____ placer mining claim has been located by
Good Earth Minerals, LLC whose current mailing
address is 600 17th Street, Suite 2800 South
Denver, Colorado 80202

BLM
Date
Stamp

The general course of this claim is North to South and it is situated in
Mohave County, Arizona.

This claim is 1320 feet in length and 660 feet in width. This claim runs from the
location monument on which this location notice is posted approximately 1300 feet in a North
direction to the North end line and 640 feet in a East direction to the East end line.
This claim is marked by four monuments, one at each corner of the claim.

The location monument on which this notice is posted is situated within Section 3, Township
41 N, Range 11 W, Gila Salt River Base and Meridian, Arizona. This claim encompasses
portions of the following legal subdivision(s) if located by legal subdivision or the following quarter section (s),
section (s), Township (s) and Range (s) E1/2E1/2NE1/4SW1/4, W1/2W1/2NW1/4SE1/4, Sec. 3,
T41N R11W, Gila Salt River Base and Meridian, Arizona.

The locality of this claim with reference to some natural object or permanent monument and additional
information (if any) concerning its locality are as follows: _____

DATED AND POSTED on the ground this 9TH day of November, 20 11.

LOCATOR(S) Janice Jones, mgr. Fred Johnson AGENT

Janice Jones, Manager

Form MCF102
Revised July 2005

This form is available from the Arizona Department of Mines & Mineral Resources and may be reproduced.

ANCH 13451

MINING CLAIM MAP

Lode () Placer (X)

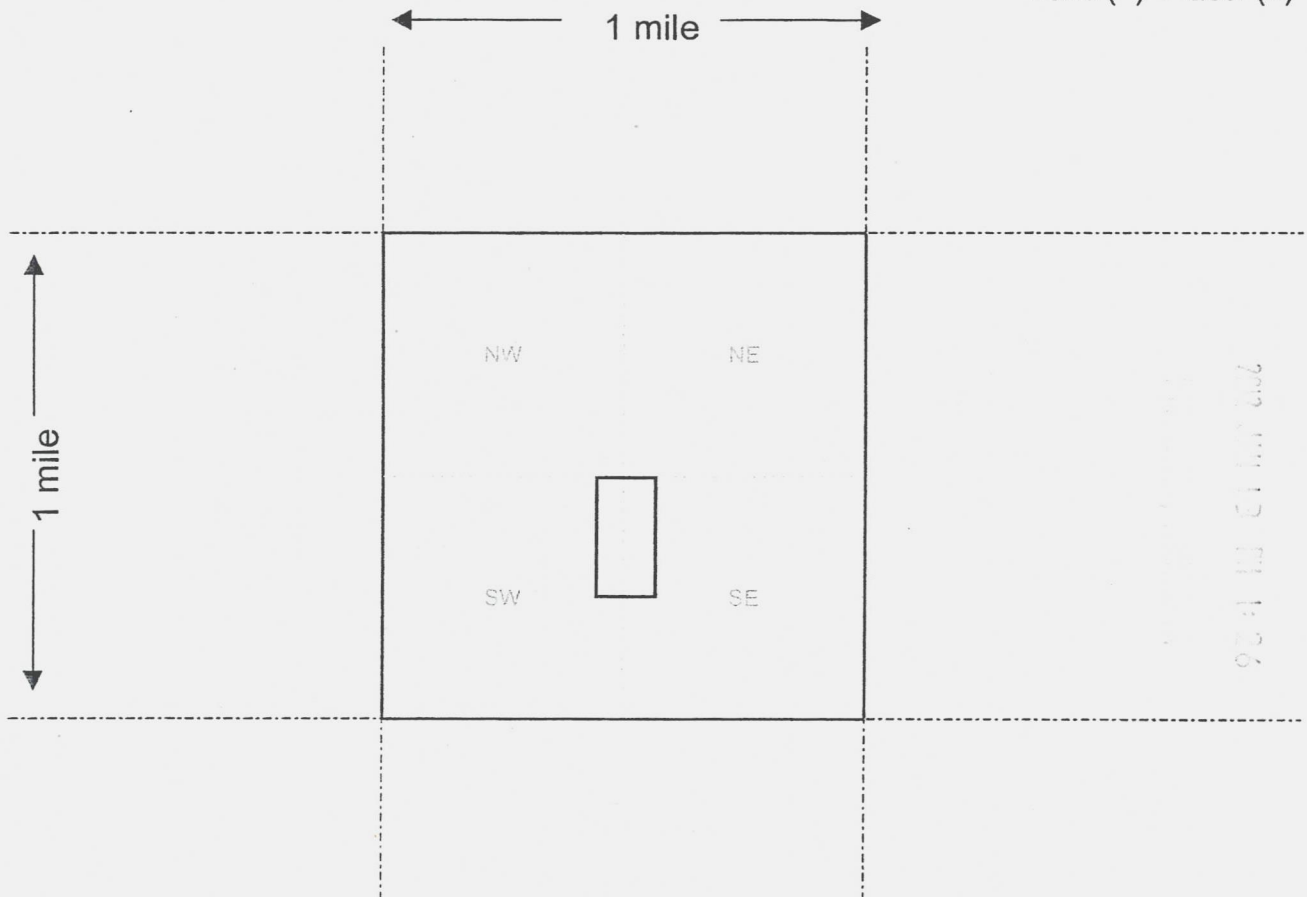

Scale : 1" = 2000 feet



1. The above map depicts the GEM SUN 2 mining claim, which is located in Section (s) 3, Township 41 N, Range 11 W, Gila and Salt River Base and Meridian, Mohave County, Arizona.
2. The type of corner and location monuments used are as follows: Capped 2in.dia.X 5ft. PVC post with a metal tag.
3. The bearings and distances in degrees and feet between claim corners are as depicted on the map.

Form MCF100a
Revised July 2005

This form is available from the Arizona Department of Mines & Mineral Resources and may be reproduced.

RECEIVED
BIA AREA OFFICE
2012 JUN 13 PM 1:26

AMC 413451

AMC 413452

MINING CLAIM MAP

Lode () Placer (X)

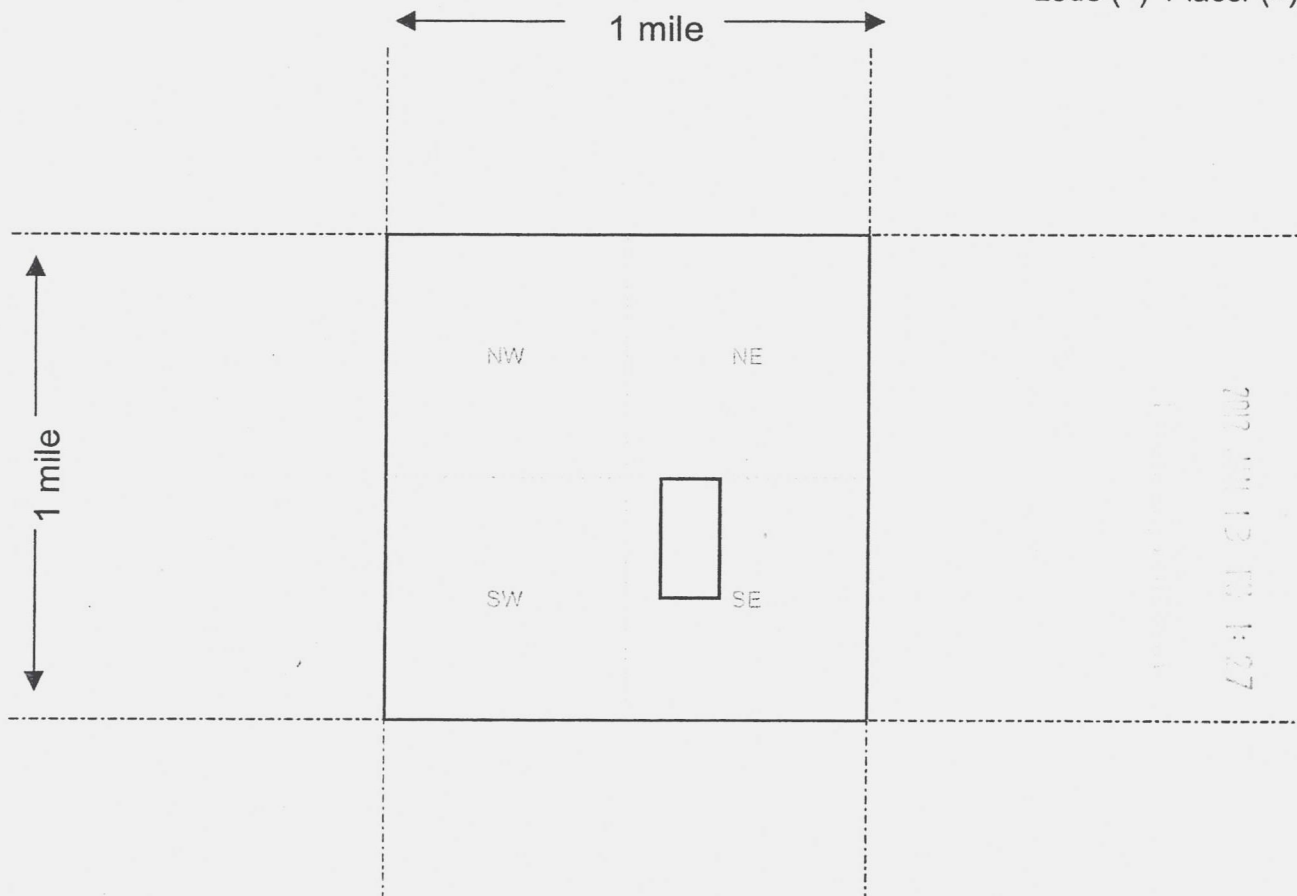

1. The above map depicts the GEM SUN 3 mining claim, which is located in Section (s) 3, Township 41 N, Range 11 W, Gila and Salt River Base and Meridian, Mohave County, Arizona.
2. The type of corner and location monuments used are as follows: Capped 2in.dia.X 5ft. PVC post with a metal tag.
3. The bearings and distances in degrees and feet between claim corners are as depicted on the map.

Form MCF100a
Revised July 2005

This form is available from the Arizona Department of Mines & Mineral Resources and may be reproduced.

AMC413452



FEE# 2011062340

OFFICIAL RECORDS
OF MOHAVE COUNTY
CAROL MEIER,
COUNTY RECORDER



12/12/2011 02:23 PM Fee: \$14.00

PAGE: 1 of 2

LOCATION NOTICE FOR PLACER MINING CLAIM

NOTICE IS HEREBY GIVEN that the GEM SUN 4

_____ placer mining claim has been located by

Good Earth Minerals, LLC whose current mailing

address is 600 17th Street, Suite 2800 South

Denver, Colorado 80202

BLM
Date
Stamp

2011 DEC 12 PM 1:27

RECORDED
INDEXED

The general course of this claim is North to South and it is situated in
Mohave County, Arizona.

This claim is 1320 feet in length and 660 feet in width. This claim runs from the
location monument on which this location notice is posted approximately 1300 feet in a South
direction to the South end line and 640 feet in a East direction to the East end line.

This claim is marked by four monuments, one at each corner of the claim.

The location monument on which this notice is posted is situated within Section 3, Township
41 N, Range 11 W, Gila Salt River Base and Meridian, Arizona. This claim encompasses
portions of the following legal subdivision(s) if located by legal subdivision or the following quarter section (s),
section (s), Township (s) and Range (s) E1/2E1/2NW1/4SE1/4, W1/2W1/2NE1/4SE1/4, Sec. 3,
T41N R11W, Gila Salt River Base and Meridian, Arizona.

The locality of this claim with reference to some natural object or permanent monument and additional
information (if any) concerning its locality are as follows: _____

DATED AND POSTED on the ground this 9TH day of November, 20 11.

LOCATOR (s) Janice Jones, Mgr. Frederic Johnson AGENT

Janice Jones, Manager

Form MCF102
Revised July 2005

This form is available from the Arizona Department of Mines & Mineral Resources and may be reproduced.

AMC413453

MINING CLAIM MAP

Lode () Placer (X)

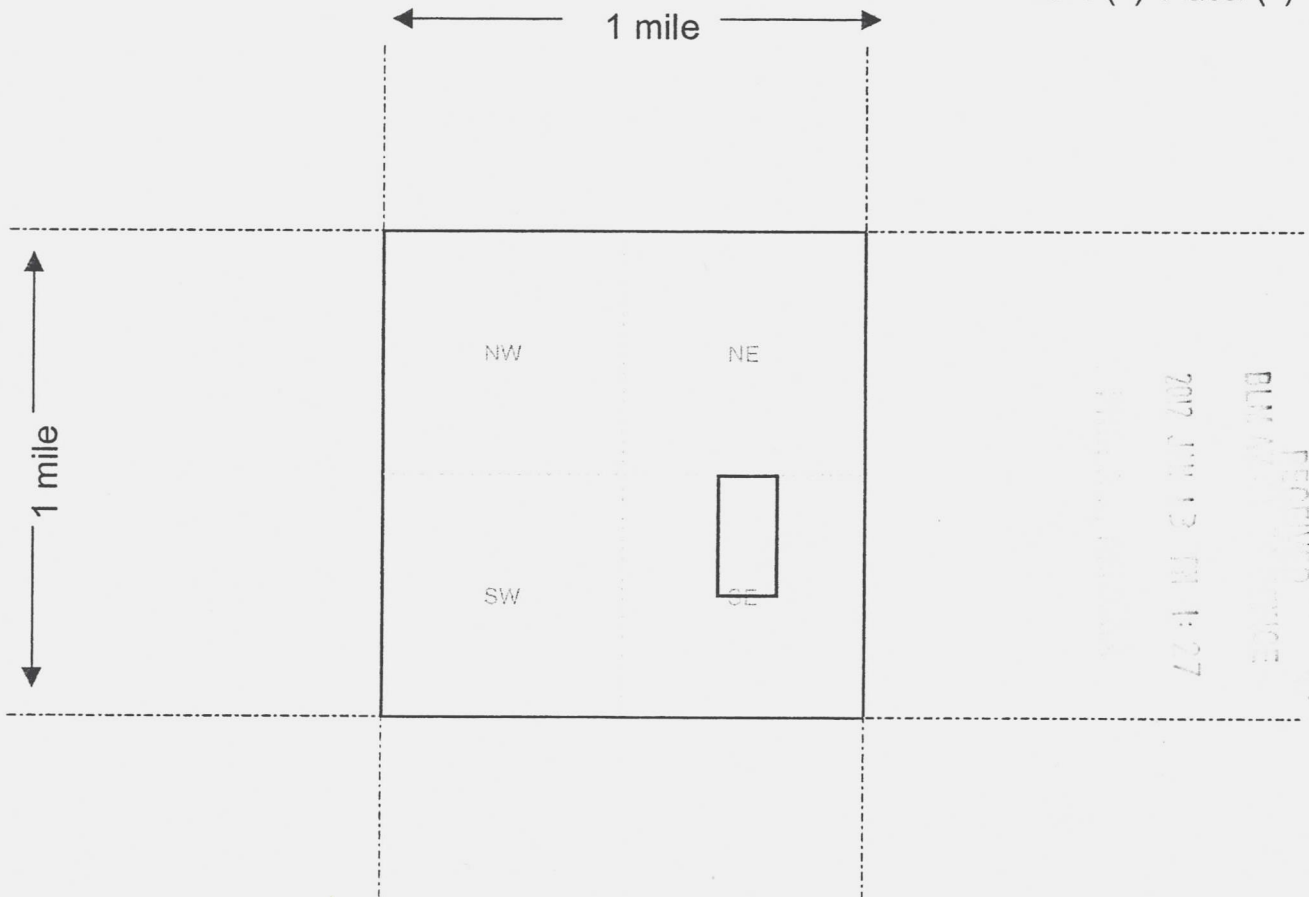

1. The above map depicts the GEM SUN 4 mining claim, which is located in Section (s) 3, Township 41 N, Range 11 W, Gila and Salt River Base and Meridian, Mohave County, Arizona.
2. The type of corner and location monuments used are as follows: Capped 2in.dia.X 5ft. PVC post with a metal tag.
3. The bearings and distances in degrees and feet between claim corners are as depicted on the map.

Form MCF100a
Revised July 2005

This form is available from the Arizona Department of Mines & Mineral Resources and may be reproduced.

AMC413453

This form is available from the **Arizona Department of Mines & Mineral Resources** and may be reproduced.

100-100000

АНСЧ 13454

MINING CLAIM MAP

Lode () Placer (X)

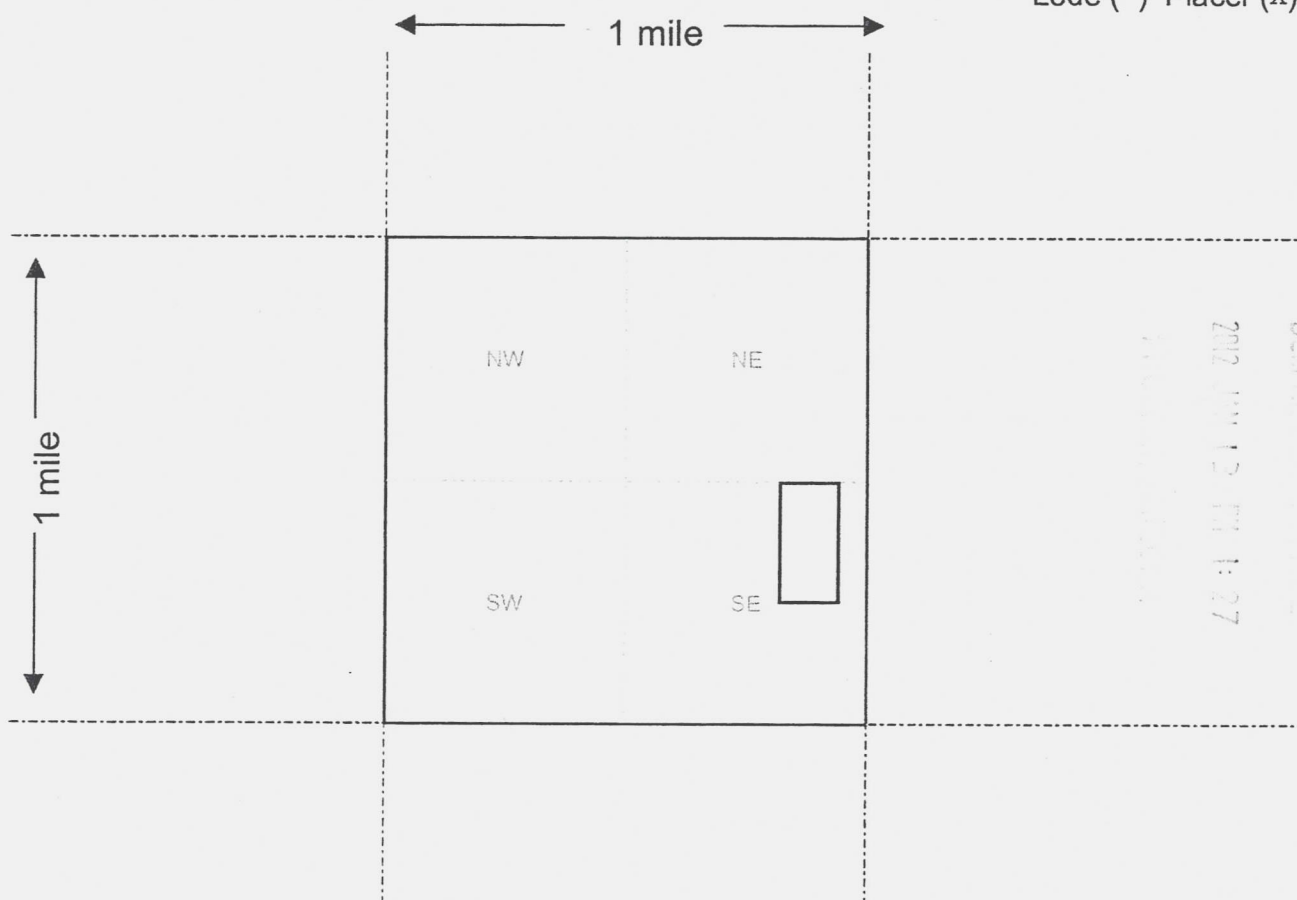

Scale : 1" = 2000 feet



1. The above map depicts the GEM SUN 5 mining claim, which is located in Section (s) 3, Township 41 N, Range 11 W, Gila and Salt River Base and Meridian, Mohave County, Arizona.
2. The type of corner and location monuments used are as follows: Capped 2in.dia.X 5ft. PVC post with a metal tag.
3. The bearings and distances in degrees and feet between claim corners are as depicted on the map.

Form MCF100a
Revised July 2005

This form is available from the Arizona Department of Mines & Mineral Resources and may be reproduced.

RECEIVED
BUREAU OF LANDS
2012 JUN 12 PM 1:27

AMC 413454

FEE# 2011062342

OFFICIAL RECORDS
OF MOHAVE COUNTY
CAROL MEIER,
COUNTY RECORDER



12/12/2011 02:23 PM Fee: \$14.00

PAGE: 1 of 2

LOCATION NOTICE FOR PLACER MINING CLAIM

NOTICE IS HEREBY GIVEN that the GEM SUN 6

_____ placer mining claim has been located by

Good Earth Minerals, LLC whose current mailing
address is 600 17th Street, Suite 2800 South
Denver, Colorado 80202

BLM
Date
Stamp[illegible]

RECEIVED
BLM 4/20/1964

The general course of this claim is West to East and it is situated in
Mohave County, Arizona.

This claim is 660 feet in length and 1320 feet in width. This claim runs from the location monument on which this location notice is posted approximately 640 feet in a South direction to the South end line and 1300 feet in a West direction to the West end line.

This claim is marked by four monuments, one at each corner of the claim.

The location monument on which this notice is posted is situated within Section 3, Township 41 N, Range 11 W, Gila Salt River Base and Meridian, Arizona. This claim encompasses portions of the following legal subdivision(s) if located by legal subdivision or the following quarter section (s), section (s), Township (s) and Range (s) E1/2SW1/4SE1/4NW1/4, SE1/4SE1/4NW1/4, W1/2SW1/4SW1/4NE1/4, Sec.3, T41N R11W, Gila Salt River Base and Meridian, Arizona.

The locality of this claim with reference to some natural object or permanent monument and additional information (if any) concerning its locality are as follows:

DATED AND POSTED on the ground this 9TH day of November, 20 11

LOCATOR(s) Janice Jones, Mgr. Frederic Johnson AGENT

Form MCF102
Revised July 2005

This form is available from the **Arizona Department of Mines & Mineral Resources** and may be reproduced.

AMC 413455

MINING CLAIM MAP

Lode () Placer (X)

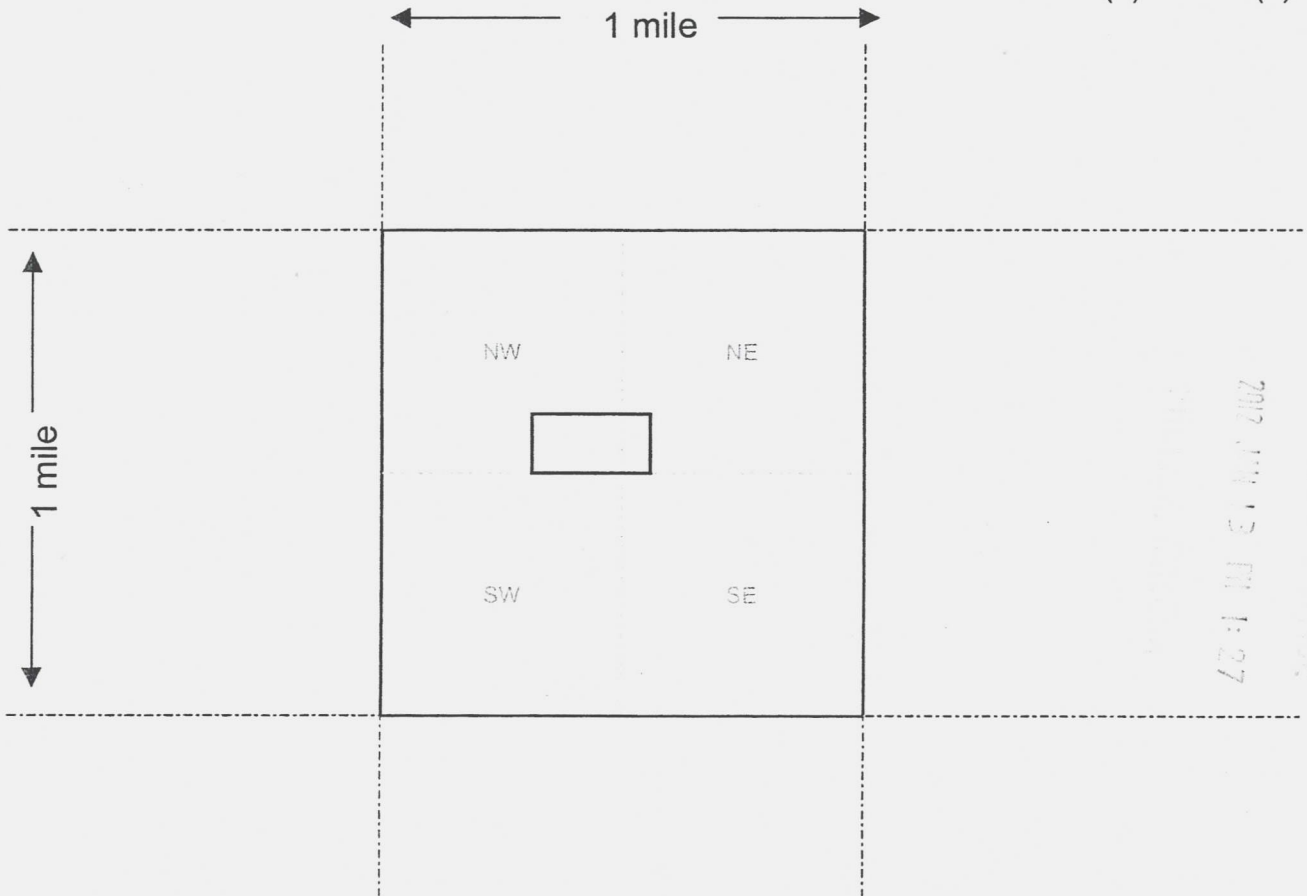

Scale : 1" = 2000 feet



1. The above map depicts the GEM SUN 6 mining claim, which is located in Section (s) 3, Township 41 N, Range 11 W, Gila and Salt River Base and Meridian, Mohave County, Arizona.
2. The type of corner and location monuments used are as follows: Capped 2in.dia.X 5ft. PVC post with a metal tag.
3. The bearings and distances in degrees and feet between claim corners are as depicted on the map.

Form MCF100a
Revised July 2005

This form is available from the Arizona Department of Mines & Mineral Resources and may be reproduced.

RECEIVED
BLM ARIZONA SERVICE
2012 JUL 13 PM 1:27
AMC413455

MINING CLAIM MAP

Lode () Placer (X)

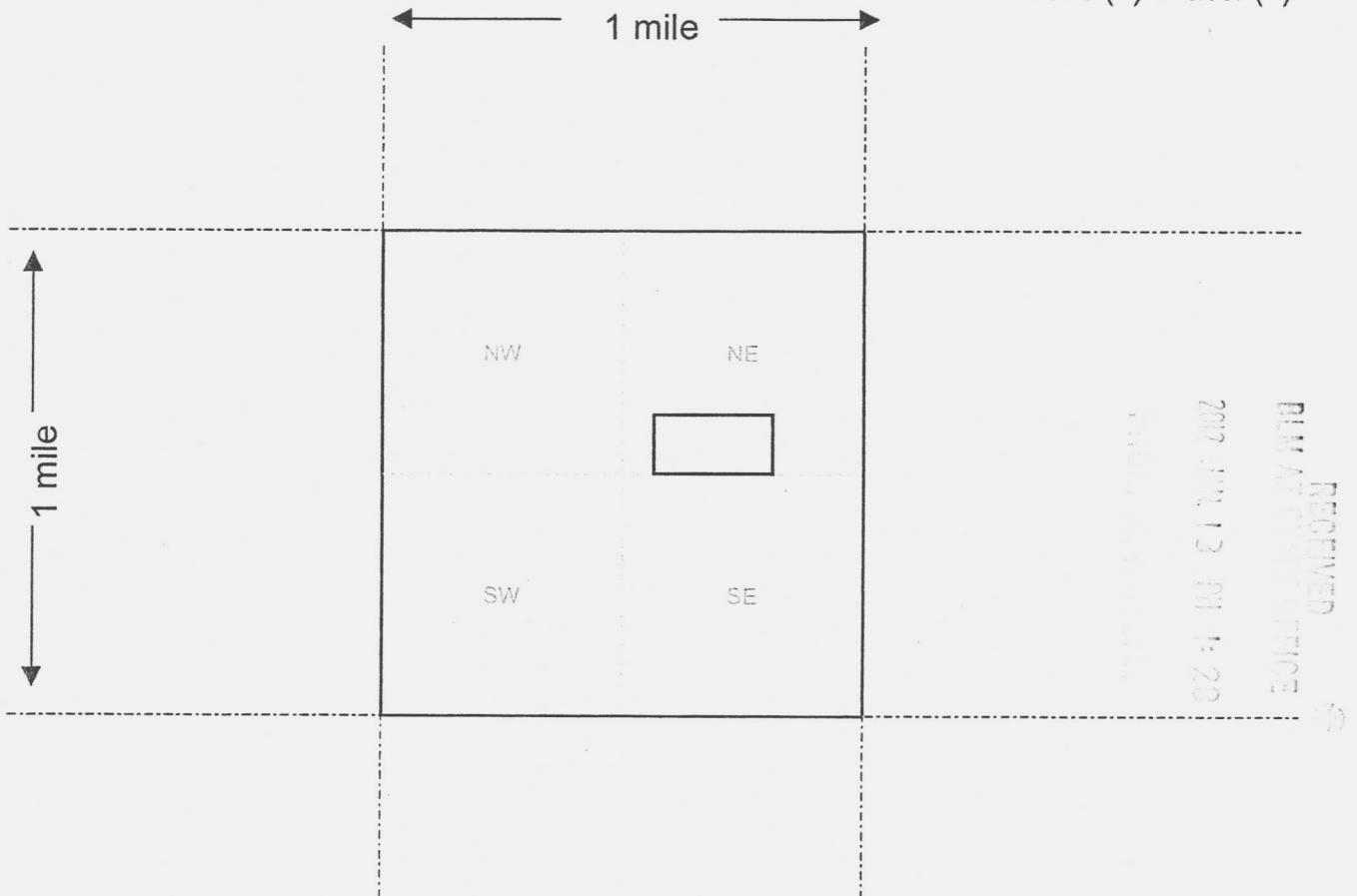

Scale : 1" = 2000 feet



1. The above map depicts the GEM SUN 7 mining claim, which is located in Section (s) 3, Township 41 N, Range 11 W, Gila and Salt River Base and Meridian, Mohave County, Arizona.
2. The type of corner and location monuments used are as follows: Capped 2in.dia.X 5ft. PVC post with a metal tag.
3. The bearings and distances in degrees and feet between claim corners are as depicted on the map.

Form MCF100a
Revised July 2005

This form is available from the Arizona Department of Mines & Mineral Resources and may be reproduced.

AMC413456

RECEIVED
BLM ARIZONA OFFICE
2012 JUN 13 PM 1:20



FEE# 2011062344

OFFICIAL RECORDS
OF MOHAVE COUNTY
CAROL MEIER,
COUNTY RECORDER



12/12/2011 02:23 PM Fee: \$14.00

PAGE: 1 of 2

LOCATION NOTICE FOR PLACER MINING CLAIM

NOTICE IS HEREBY GIVEN that the GEM SUN 8
_____ placer mining claim has been located by
Good Earth Minerals, LLC whose current mailing
address is 600 17th Street, Suite 2800 South
Denver, Colorado 80202

BLM
Date
Stamp

RECORDED
2011 DEC 13 02:23 PM
FEE \$14.00

The general course of this claim is North to South and it is situated in
Mohave County, Arizona.

This claim is 1320 feet in length and 660 feet in width. This claim runs from the
location monument on which this location notice is posted approximately 1300 feet in a North
direction to the North end line and 640 feet in a West direction to the West end line.
This claim is marked by four monuments, one at each corner of the claim.

The location monument on which this notice is posted is situated within Section 3, Township
41 N, Range 11 W, Gila Salt River Base and Meridian, Arizona. This claim encompasses
portions of the following legal subdivision(s) if located by legal subdivision or the following quarter section (s),
section (s), Township (s) and Range (s) E1/2NE1/4SE1/4NW1/4, E1/2SE1/4NE1/4NW1/4, W1/2SW1/4
NW1/4NE1/4, W1/2NW1/4SW1/4SW1/4, Sec. 3, Gila Salt River Base and Meridian, Arizona.
T41N R11W

The locality of this claim with reference to some natural object or permanent monument and additional
information (if any) concerning its locality are as follows: _____

DATED AND POSTED on the ground this 9TH day of November, 20 11.

LOCATOR(s) Janice Jones, Mgr., Frederic Johnson AGENT

Janice Jones, Manager

Form MCF102
Revised July 2005

This form is available from the Arizona Department of Mines & Mineral Resources and may be reproduced.

A11C413457

MINING CLAIM MAP

Lode () Placer (X)

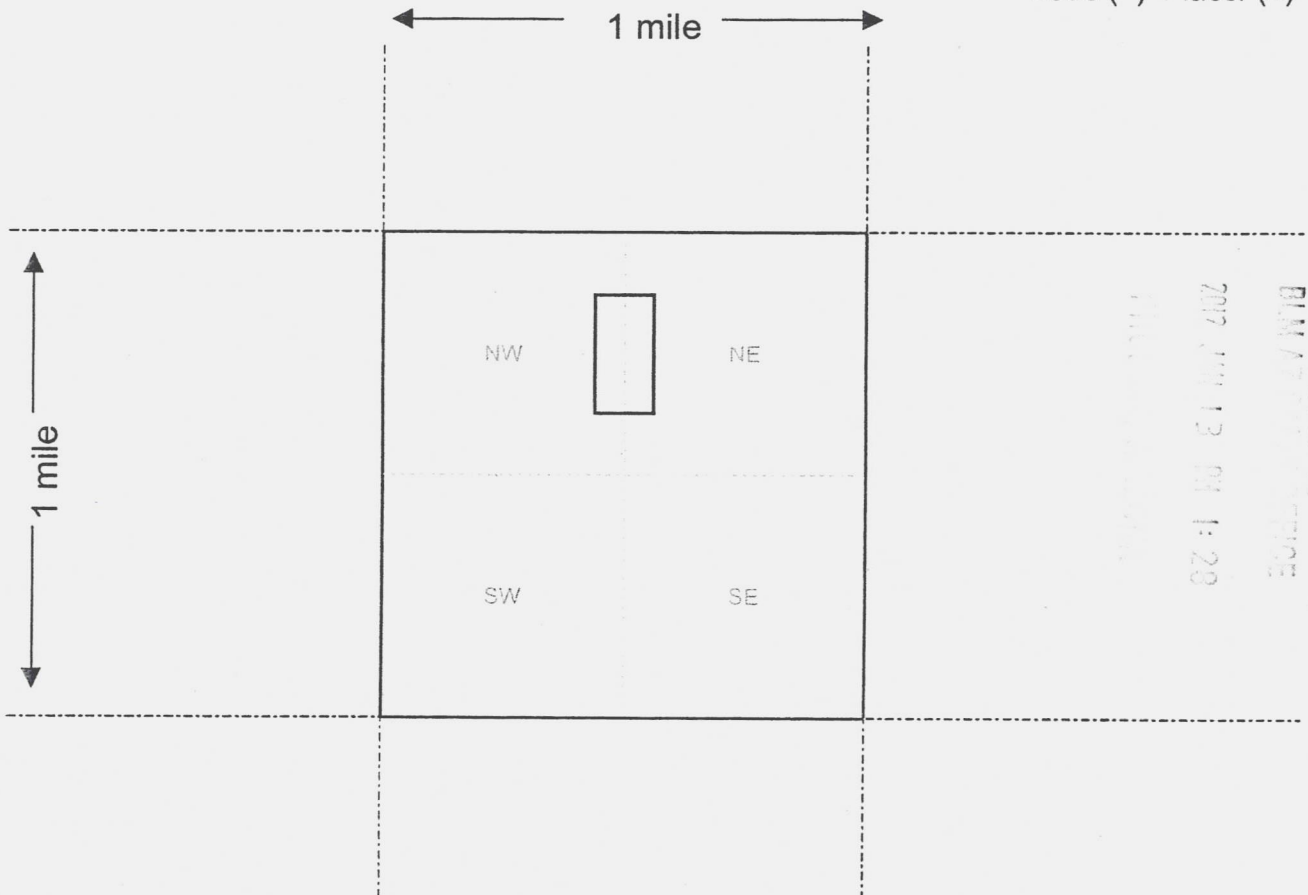

Scale : 1" = 2000 feet



1. The above map depicts the GEM SUN 8 mining claim, which is located in Section (s) 3, Township 41 N, Range 11 W, Gila and Salt River Base and Meridian, Mohave County, Arizona.
2. The type of corner and location monuments used are as follows: Capped 2in.dia.X 5ft. PVC post with a metal tag.
3. The bearings and distances in degrees and feet between claim corners are as depicted on the map.

Form MCF100a
Revised July 2005

This form is available from the **Arizona Department of Mines & Mineral Resources** and may be reproduced.

AMC413457



FEE# 2011062345

OFFICIAL RECORDS
OF MOHAVE COUNTY
CAROL MEIER,
COUNTY RECORDER



12/12/2011 02:23 PM Fee: \$14.00

PAGE: 1 of 2

RECEIVED
FEE
12/13/11 PM 1:28

ANCH 13458

LOCATION NOTICE FOR PLACER MINING CLAIM

NOTICE IS HEREBY GIVEN that the GEM SUN 9
_____ placer mining claim has been located by
Good Earth Minerals, LLC whose current mailing
address is 600 17th Street, Suite 2800 South
Denver, Colorado 80202

BLM
Date
Stamp

The general course of this claim is West to East and it is situated in
Mohave County, Arizona.

This claim is 660 feet in length and 1320 feet in width. This claim runs from the
location monument on which this location notice is posted approximately 640 feet in a North
direction to the North end line and 1300 feet in a East direction to the East end line.
This claim is marked by four monuments, one at each corner of the claim.

The location monument on which this notice is posted is situated within Section 3, Township
41 N, Range 11 W, Gila Salt River Base and Meridian, Arizona. This claim encompasses
portions of the following legal subdivision(s) if located by legal subdivision or the following quarter section (s),
section (s), Township (s) and Range (s) E1/2SW1/4NW1/4SW1/4, NE1/4SW1/4NE1/4,
W1/2NW1/4SE1/4NE1/4, Sec.3, T41N R11W, Gila Salt River Base and Meridian, Arizona.

The locality of this claim with reference to some natural object or permanent monument and additional
information (if any) concerning its locality are as follows: _____

DATED AND POSTED on the ground this 9TH day of November, 20 11.

LOCATOR(s) Janice Jones Mgr, Frederic Johnson AGENT

Janice Jones Manager

Form MCF102
Revised July 2005

MINING CLAIM MAP

Lode () Placer (X)

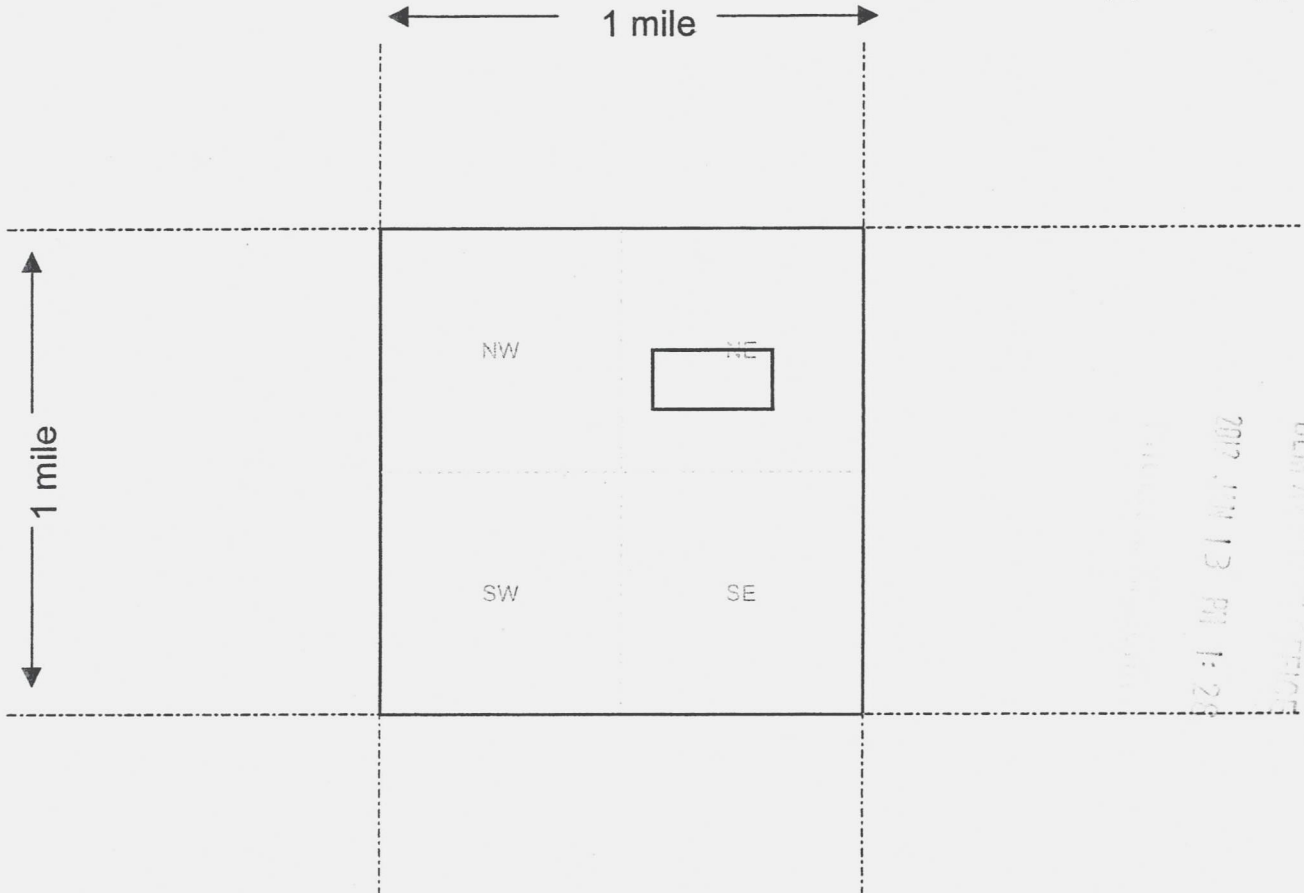

Scale : 1" = 2000 feet



1. The above map depicts the GEM SUN 9 mining claim, which is located in Section (s) 3, Township 41 N, Range 11 W, Gila and Salt River Base and Meridian, Mohave County, Arizona.
2. The type of corner and location monuments used are as follows: Capped 2in.dia.X 5ft. PVC post with a metal tag.
3. The bearings and distances in degrees and feet between claim corners are as depicted on the map.

Form MCF100a
Revised July 2005

This form is available from the Arizona Department of Mines & Mineral Resources and may be reproduced.

RECEIVED
BLM ARIZONA
2012 JUN 13 PM 1:21

AMC 413458



FEE# 2011062346

OFFICIAL RECORDS
OF MOHAVE COUNTY
CAROL MEIER,
COUNTY RECORDER



12/12/2011 02:23 PM Fee: \$14.00

PAGE: 1 of 2

LOCATION NOTICE FOR PLACER MINING CLAIM

NOTICE IS HEREBY GIVEN that the GEM SUN 10
_____ placer mining claim has been located by
Good Earth Minerals, LLC whose current mailing
address is 600 17th Street, Suite 2800 South
Denver, Colorado 80202

BLM
Date
Stamp

2012 JAN 13 PM 1:25

RECEIVED
BLM/MOHAVE COUNTY
2012 JAN 13 PM 1:25

The general course of this claim is West to East and it is situated in
Mohave County, Arizona.

This claim is 660 feet in length and 1320 feet in width. This claim runs from the
location monument on which this location notice is posted approximately 640 feet in a South
direction to the South end line and 1300 feet in a West direction to the West end line.
This claim is marked by four monuments, one at each corner of the claim.

The location monument on which this notice is posted is situated within Section 2, Township
41 N, Range 11 W, Gila Salt River Base and Meridian, Arizona. This claim encompasses
portions of the following legal subdivision(s) if located by legal subdivision or the following quarter section (s),
section (s), Township (s) and Range (s) S1/2SW1/4SW1/4, Sec.2, T41N R11W
_____, Gila Salt River Base and Meridian, Arizona.

The locality of this claim with reference to some natural object or permanent monument and additional
information (if any) concerning its locality are as follows: _____

DATED AND POSTED on the ground this 9TH day of November, 2011.

LOCATOR (s) Janice Jones, Mgr. Frederic Johnson AGENT

Janice Jones, Manager

Form MCF102
Revised July 2005

AMC413459

MINING CLAIM MAP

Lode () Placer (X)

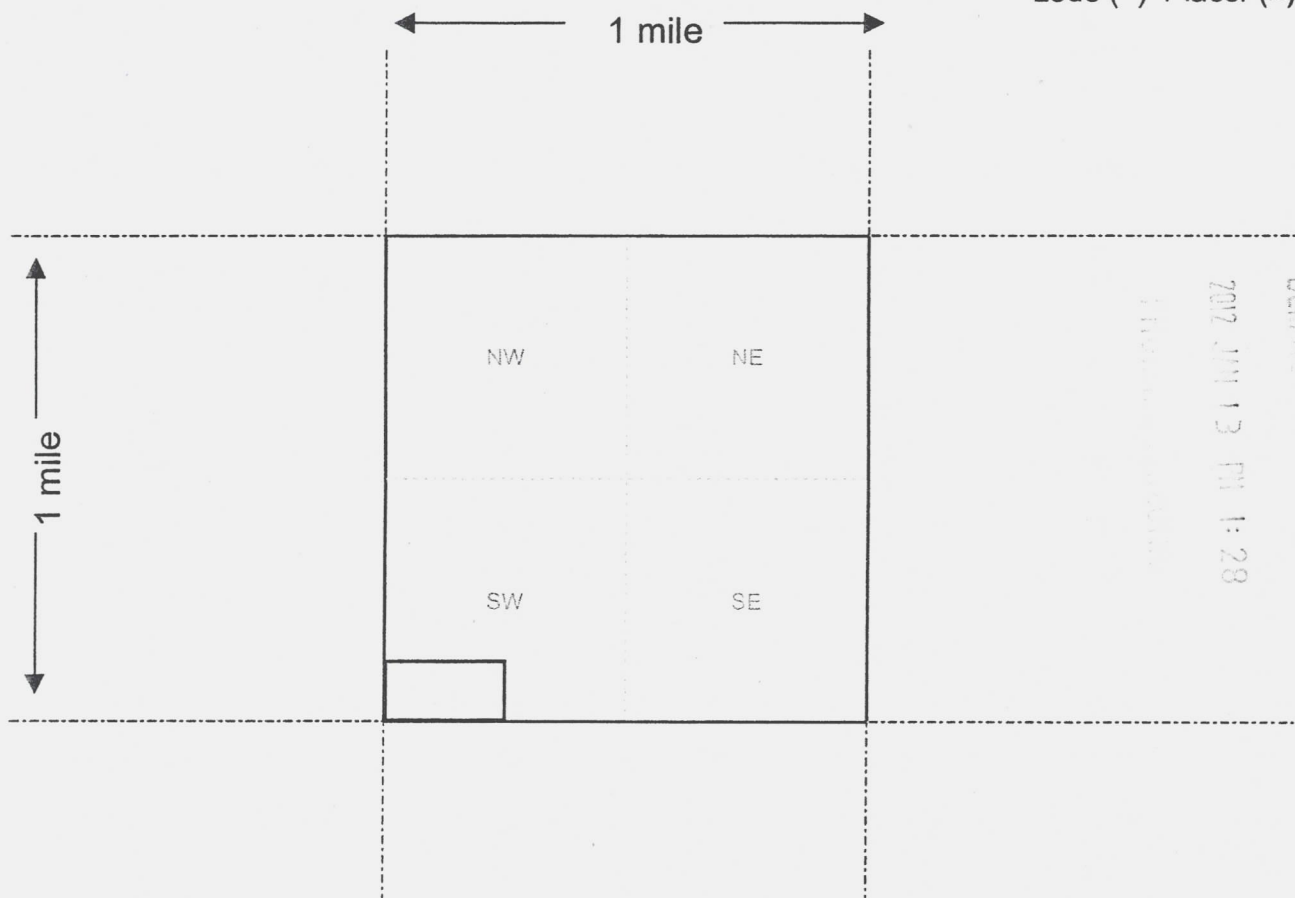

Scale : 1" = 2000 feet



1. The above map depicts the GEM SUN 10 mining claim, which is located in Section (s) 2, Township 41 N, Range 11 W, Gila and Salt River Base and Meridian, Mohave County, Arizona.
2. The type of corner and location monuments used are as follows: Capped 2in.dia.X 5ft. PVC post with a metal tag.
3. The bearings and distances in degrees and feet between claim corners are as depicted on the map.

Form MCF100a
Revised July 2005

This form is available from the Arizona Department of Mines & Mineral Resources and may be reproduced.

RECEIVED
BLM AZ DIST OFFICE
2012 JUN 13 PM 1:28

ANC413459

OFFICIAL RECORDS
OF MOHAVE COUNTY
CAROL MEIER,
COUNTY RECORDER



12/12/2011 02:23 PM Fee: \$14.00

PAGE: 1 of 2

NOTICE IS HEREBY GIVEN that the GEM SUN 11

_____ placer mining claim has been located by
Good Earth Minerals, LLC whose current mailing
 address is 600 17th Street, Suite 2800 South
Denver, Colorado 80202

BLM
Date
Stamp

100-1000

RECEIVED
BUREAU OF
MINE

The general course of this claim is West to East and it is situated in Mohave County, Arizona.

This claim is 660 feet in length and 1320 feet in width. This claim runs from the location monument on which this location notice is posted approximately 640 feet in a North direction to the North end line and 1300 feet in a West direction to the West end line. This claim is marked by four monuments, one at each corner of the claim.

The location monument on which this notice is posted is situated within Section 2, Township 41 N, Range 11 W, Gila Salt River Base and Meridian, Arizona. This claim encompasses portions of the following legal subdivision(s) if located by legal subdivision or the following quarter section (s), section (s), Township (s) and Range (s) N1/2SW1/4SW1/4, Sec.2, T41N R11W

Gila Salt River Base and Meridian, Arizona.

The locality of this claim with reference to some natural object or permanent monument and additional information (if any) concerning its locality are as follows: _____

DATED AND POSTED on the ground this 9TH day of November, 20 11.

LOCATOR(s) Janice Jones Mx. Frederic Johnson AGENT

Form MCF102
Revised July 2005

This form is available from the **Arizona Department of Mines & Mineral Resources** and may be reproduced.

AMC 3160

MINING CLAIM MAP

Lode () Placer (X)

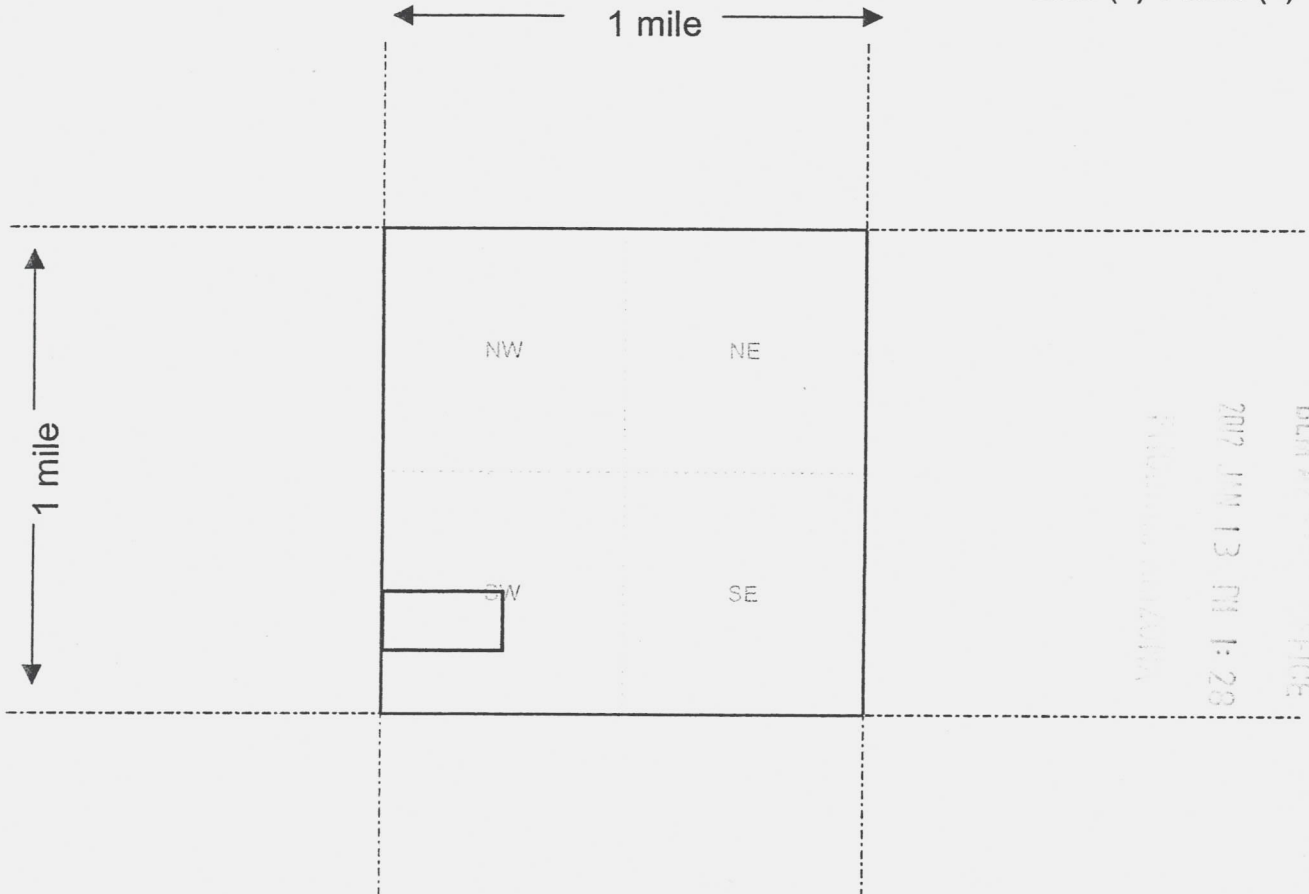

Scale : 1" = 2000 feet



1. The above map depicts the GEM SUN 11 mining claim, which is located in Section (s) 2, Township 41 N, Range 11 W, Gila and Salt River Base and Meridian, Mohave County, Arizona.
2. The type of corner and location monuments used are as follows: Capped 2in.dia.X 5ft. PVC post with a metal tag.
3. The bearings and distances in degrees and feet between claim corners are as depicted on the map.

Form MCF100a
Revised July 2005

This form is available from the Arizona Department of Mines & Mineral Resources and may be reproduced.

RECEIVED
BLM AT SALT RIVER OFFICE
2012 JUL 13 PM 1:28

AMC 413460

Good Earth Minerals, LLC

January 9, 2012

U.S. Bureau of Land Management
Arizona State Office
One North Central Avenue, Suite 800
Phoenix, Arizona 85004-4427
602-417-9200

Dear Sirs:

Please file these eleven (11) mining claims (GEM SUN # 1, 2, 3, 5, 6, 7, 8, 9, 10, and 11). A check for \$189 per claim (\$2079) and a claim map are enclosed.

Each claim has an individual respective claim map attached.

Please return all filing receipts to the address noted above and on the recorded documents.

Thank you very much for your help.

Sincerely,

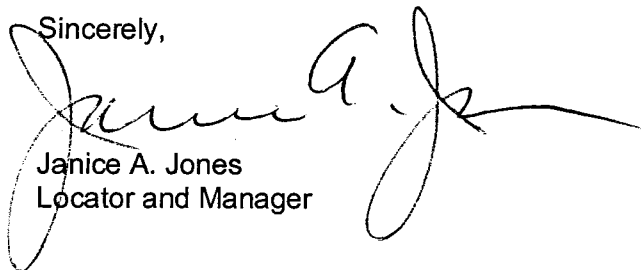

Janice A. Jones
Locator and Manager

600 17th St., Suite 2800 South, Denver, CO 80202-5428
Office (303) 804-0100 Fax (720) 283-1857

GEMSUN

Good Earth Minerals, LLC
600 17th Street, Suite 2800 South
Denver CO 80202-5428

PLACE STICKER AT TOP OF ENVELOPE TO THE RIGHT
OF THE RETURN ADDRESS. FOLD AT DOTTED LINE

CERTIFIED MAIL™



7011 2000 0000 7752 8154



1000

85004

U.S. POSTAGE
PAID
LITTLETON, CO
80120
JAN 10, 12
AMOUNT

\$6.83
00058897-12

RETURN RECEIPT
REQUESTED

U.S. Bureau of Land Management
Arizona State Office
One North Central Office
Phoenix AZ 85004-4427

RETURN RECEIPT
REQUESTED

RUN TIME: 08:10 AM

DEPARTMENT OF INTERIOR
BUREAU OF LAND MANAGEMENT

RUN DATE: 02/01/2012
Page 1 of 1

Input Parameters for Geographic Report with Land

System Id = CR

Admin State = AZ

Geo State = AZ

Casetype Begins With

Case Disp Txt = AUTHORIZED, CANCELLED, EXPIRED, PENDING, REJECTED, RELINQUISHED, WITHDRAWN

Mer Twp Rng = 14 0410N 0110W

Section = 002, 003, 999

Mtrs =

Commodity =

Commodity Txt =

Pending Org =

Pend Org Decode =

Total Rows Returned: 5

NO WARRANTY IS MADE BY BLM FOR USE OF THE DATA
FOR PURPOSES NOT INTENDED BY BLM

RUN TIME: 08:10 AM

Adm State: AZ

UNITED STATES DEPARTMENT OF INTERIOR
BUREAU OF LAND MANAGEMENT
GEOGRAPHIC REPORT WITH LAND
Sorted by Meridian Township Range

RUN DATE: 02/01/2012
Page 1 of 1

Serial Number: AZA 010138

Total Case Acres: 630.000

<u>Casetype</u>	<u>Case Disp</u>	14	0410N	0110W	<u>Sect</u>	<u>Sur Typ</u>	<u>Sur Num</u>	<u>Suff</u>	<u>Subdivision</u>	<u>Act Pend</u>
285003	AUTHORIZED				002	ALIQ MNR		1	SENE,SE; SESESW;	

Serial Number: AZA 028213

Total Case Acres: 0.500

<u>Casetype</u>	<u>Case Disp</u>	14	0410N	0110W	<u>Sect</u>	<u>Sur Typ</u>	<u>Sur Num</u>	<u>Suff</u>	<u>Subdivision</u>	<u>Act Pend</u>
380913	AUTHORIZED				003	ALIQ			SESE;	

Serial Number: AZA 033168

Total Case Acres: 642.440

<u>Casetype</u>	<u>Case Disp</u>	14	0410N	0110W	<u>Sect</u>	<u>Sur Typ</u>	<u>Sur Num</u>	<u>Suff</u>	<u>Subdivision</u>	<u>Act Pend</u>
312021	AUTHORIZED				003	ALIQ LOTS			S2N2,S2; 1-4;	

MOHAVE COUNTY
ARIZONA STRIP DISTRICT OFFICE

[illegible][illegible]

FOR ORDERS AFFECTING DISPOSAL OR USE OF
UNIDENTIFIED LANDS WITHDRAWN FOR CLASSIFICATION,
MINERALS, WATER AND/OR OTHER PUBLIC PURPOSES,
REFER TO INDEX OF MISCELLANEOUS DOCUMENTS.

Grazing Dist No 1

Lot 36°54'13"N
 Long 113°25'28"W

SCALE in chains

WARNING STATEMENT
This plat is the Bureau's Record of Title, and should be used only as a graphic display of the township survey data. Records hereon do not reflect title changes which may have been effected by lateral movements of rivers or other bodies of water. Refer to the cadastral surveys for official survey information.

CURRENT TO	NW	GSR Mer
3-16-2010	ACAD	T 41 N
		R 11 W